

## SUSPENSION SYSTEMS

### 15/16" Classic Stab System



\$\$\$

#### TOOLS

Visit [CertainTeed.com/Ceilings](http://CertainTeed.com/Ceilings)  
Download Technical Brochures  
LEED® Information / BIM Objects  
3-Part Specs / Data Pages

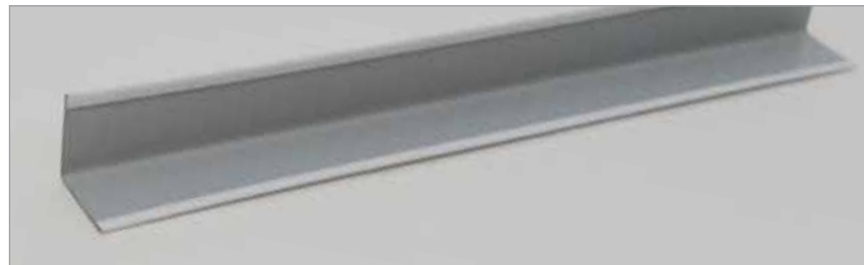
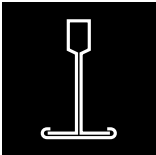

15/16" Wall Angle



#### CROSS TEE



#### 15/16" WALL ANGLE



The Classic Stab System features the 15/16" (24 mm) face width that is widely used in interior designs today. Strong staked-on end tabs are incorporated into the cross tee design to provide quick and easy installation with optimal tightness among installed components.

#### FEATURES & BENEFITS

- Double web design for durability and strength
- Cross tees feature staked-on end tabs for optimal tightness and ease of installation
- Intermediate- and heavy-duty load-bearing capabilities
- Stepped-end design featured on cross tees
- Grid features G30 hot-dipped galvanized steel web construction for corrosion resistance
- Available in standard white and black
- Suitable for all seismic applications
- Compliant with ICC ESR 3336 L.A. Research Report number 25978
- High recycled content - 3rd party certified

#### AVAILABLE EDGE DETAILS



Trim  
(Square)  
15/16 Grid



Reveal  
15/16 Grid



Reveal  
(Beveled)  
15/16 Grid



Reveal  
(Corner Beveled)  
15/16 Grid





Semi-Concealed  
15/16 Grid



Fully Concealed  
15/16 Grid



## ATTRIBUTES

											
	DESCRIPTION	GRID FACE (INCHES)	DIMENSIONS (INCHES)	SLOT SPACING (INCHES)	STRUCTURAL CLASSIFICATION (ASTM C635)	RECYCLED CONTENT TOTAL*	RECYCLED CONTENT PRE*	RECYCLED CONTENT POST*	SEISMIC DESIGN CATEGORY	PIECES PER CARTON	FEET PER CARTON
<b>15/16" CLASSIC STAB SYSTEM</b>											
<b>CS12-12-15</b>	Main Runner	15/16	144 x 1-1/2 x 15/16	6 O.C.	ID	88%	25%	69%	A-C	20	240
<b>CS12-12-20</b>	Main Runner	15/16	144 x 1-1/2 x 15/16	6 O.C.	HD	88%	25%	69%	A-F	20	240
<b>CS11.67-12-15</b>	Main Runner	15/16	140 x 1-1/2 x 15/16	10 O.C.	ID	88%	25%	69%	A-C	20	233
<b>CS10-12-15</b>	Main Runner	15/16	120 x 1-1/2 x 15/16	6 O.C.	ID	88%	25%	69%	A-C	20	200
<b>CS10-12-15-12S</b>	Main Runner	15/16	120 x 1-1/2 x 15/16	10 O.C.	ID	88%	25%	69%	A-C	20	200
<b>CS0.5-12-12</b>	Cross Tee	15/16	6 x 1-1/2 x 15/16	—	—	87%	24%	68%	A-F	60	30
<b>CS1-12-12</b>	Cross Tee	15/16	12 x 1-1/2 x 15/16	—	—	87%	24%	68%	—	60	60
<b>CS1.67-12-12</b>	Cross Tee	15/16	20 x 1-1/2 x 15/16	—	—	87%	24%	68%	—	60	100
<b>CS2-12-12</b>	Cross Tee	15/16	24 x 1-1/2 x 15/16	—	—	87%	24%	68%	—	60	120
<b>CS2-12-20</b>	Cross Tee	15/16	24 x 1-1/2 x 15/16	—	HD	87%	24%	68%	—	60	120
<b>CS2.5-12-12</b>	Cross Tee	15/16	30 x 1-1/2 x 15/16	—	—	87%	24%	68%	—	60	150
<b>CS4-12-12</b>	Cross Tee	15/16	48 x 1-1/2 x 15/16	12 O.C.	—	87%	24%	68%	—	60	240
<b>CS4-12-20</b>	Cross Tee	15/16	48 x 1-1/2 x 15/16	12 O.C.	HD	87%	24%	68%	—	60	240
<b>CS5-12-12</b>	Cross Tee	15/16	60 x 1-1/2 x 15/16	12 O.C.	—	87%	24%	68%	—	20	100
<b>CS5-12-12-3S</b>	Cross Tee	15/16	60 x 1-1/2 x 15/16	20, 30, 40	—	87%	24%	68%	—	20	100
<b>CS6-12-12</b>	Cross Tee	15/16	72 x 1-1/2 x 15/16	12 O.C.	—	87%	24%	68%	—	20	120
<b>CS8-12-12</b>	Cross Tee	15/16	96 x 1-1/2 x 15/16	12 O.C.	—	87%	24%	68%	—	20	160
<b>WA15-15</b>	Wall Angle	15/16	144 x 15/16 x 15/16	—	—	88%	19%	69%	—	40	480
<b>WA15-15-10</b>	Wall Angle	15/16	120 x 15/16 x 15/16	—	—	88%	19%	69%	—	40	400
<b>WA32-15-12</b>	Wall Angle	2	144 x 2 x 1	—	—	88%	19%	69%	—	40	480
<b>WA32-32-12</b>	Wall Angle	2	144 x 2 x 2	—	—	88%	19%	69%	—	40	480
<b>WA32-15</b>	Wall Angle	2	120 x 2 x 1	—	—	88%	19%	69%	—	40	400
<b>WA32-32</b>	Wall Angle	2	120 x 2 x 2	—	—	88%	19%	69%	—	40	400
<b>WA15-9</b>	Wall Angle	9/16	144 x 15/16 x 9/16	—	—	88%	19%	69%	—	40	480
<b>SM1000</b>	Shadow Molding	—	120 x 15/16 x 3/8 x 3/8 x 9/16	—	—	88%	19%	69%	—	40	400
<b>SM1020</b>	Shadow Molding	—	120 x 3/4 x 3/8 x 3/8 x 3/4	—	—	88%	19%	69%	—	40	400

		(MM)	(MM)	(MM)							
<b>15/16" CLASSIC STAB SYSTEM</b>											
<b>CS3000M-12-15</b>	Main Runner	24	3000 x 38 x 24	250 O.C.	ID	88%	25%	69%	A-C	20	197
<b>CS3600M-12-15</b>	Main Runner	24	3600 x 38 x 24	150 O.C.	ID	88%	25%	69%	A-C	20	236
<b>CS500M-12-12</b>	Cross Tee	24	500 x 38 x 24	—	—	87%	24%	68%	—	60	98
<b>CS600M-12-12</b>	Cross Tee	24	600 x 38 x 24	—	—	87%	24%	68%	—	60	118
<b>CS750M-12-12</b>	Cross Tee	24	750 x 38 x 24	—	—	87%	24%	68%	—	60	148
<b>CS1200M-12-12</b>	Cross Tee	24	1200 x 38 x 24	300 O.C.	—	87%	24%	68%	—	60	236
<b>CS1500M-12-12</b>	Cross Tee	24	1500 x 38 x 24	500 O.C.	—	87%	24%	68%	—	50	246
<b>CS1500M-12-12-5S</b>	Cross Tee	24	1500 x 38 x 24	150; 500; 750; 1000; 1350	—	87%	24%	68%	—	50	246

\*Maximum recycled content percentage. Recycled content varies by manufacturing location.

## MAIN RUNNERS

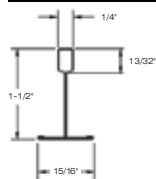

### ICC EVALUATION SERVICE, INC., REPORT COMPLIANCE

Suspension systems manufactured by CertainTeed Ceilings have been reviewed and are approved by listing in ICC-ES Evaluation Report ESR-3336. CertainTeed Ceilings suspension systems have been reviewed and are approved by listing in L.A. Research Report number 25978. Evaluation Reports are subject to reexamination, revision and possible cancellation. Refer to [CertainTeed.com/Ceilings](http://CertainTeed.com/Ceilings) for current reports.