

SBS-I-4-C

Insulated substrates: base sheet, two interply sheets and an SBS modified cap sheet

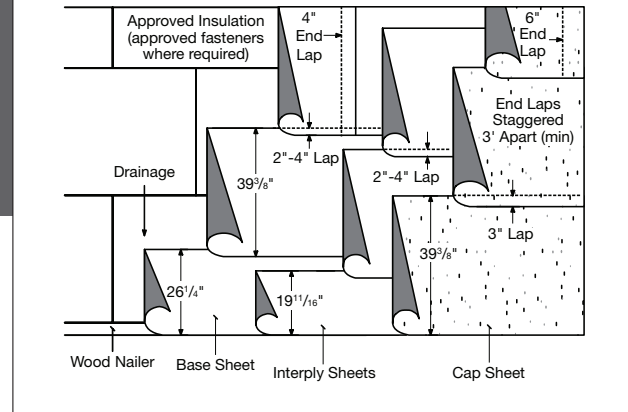

SUBSTRATE:

- Steel (Sec. 3.5)
- Concrete (Sec. 3.6-3.9)
- Wood (Sec. 3.10-3.11)
- Poured Gypsum (Sec. 3.12)
- Insulation (Sec. 4.0)
- Re-cover (Sec. 5.0)

MAXIMUM SLOPE:

Up to 6" : 12" (Sec. 15.3)

ROOF ASSEMBLY:

One or more layers of approved insulation and/or coverboard:

- Base layer mechanically attached and additional layers mechanically attached or adhered in hot asphalt or approved adhesive.
- Base layer and additional layers adhered in hot asphalt or approved adhesive.
- Vapor retarder/anchor sheets (Sec. 4.7).

Approved base sheet set in FlintBond cold process adhesive (Sec. 9.0) or self-adhered (Sec. 10.2)

Two approved interply sheets set in FlintBond cold process adhesive (Sec. 9.0) or self-adhered (10.2).

Approved cap sheet set in FlintBond cold process adhesive (Sec. 9.0).

SUMMARY OF MATERIALS:

- One or more layers of insulation and/ or coverboard
- Base sheet (1 ply)
- Interply sheets (2 plies)
- Cap sheet (1 ply)
- FlintBond adhesive (four moppings) (three moppings if base is self-adhered)

APPROVED BASE SHEETS:

(one of the following)

- All Weather/Empire® Base Sheet
- Flintlastic Base 20
- Flintlastic Poly SMS
- Flintlastic Ultra Glass SA (self-adhered)**
- Flintlastic Ultra Poly SMS

APPROVED INTERPLY SHEETS (2 PLIES):

(two of the following)

- Flintlastic Base 20
- Flintlastic Poly SMS
- Flintlastic Ultra Glass SA (self-adhered)**
- Flintlastic Ultra Poly SMS

APPROVED CAP SHEETS:

(one of the following)

- Flintlastic FR Cap 30*
- Flintlastic FR-P*
- Flintlastic GMS*
- Flintlastic Premium FR-P*

FINAL SURFACING:

For optional surfacing, see Section 14.0.

FLASHING ASSEMBLY:

- **Standard.** Over a base sheet or bonded to a primed substrate. One-ply Flintlastic modified cap sheet, per CT detail.
- **Premium.** Over a base sheet or bonded to a primed substrate. One smooth and one granulated modified membrane flashing, per CT detail.
- **Premium Alternate.** Over a base sheet or bonded to a primed substrate. One smooth modified membrane and CT SmartFlash®, per CT detail.

Asphalt: Type III or Type IV (Sec. 7.0).

Cants: In angles of roof deck and vertical surfaces, the roofing contractor shall furnish and install an approved cant strip with a minimum 3" face.

* Available with CoolStar® reflective granules

** May require torch warming in winter months (Sec. 10.2)

WARRANTY DURATIONS FOR THIS SPECIFICATION VARY BASED ON ROLL MATERIAL SELECTION; SEE WARRANTY MATRIX.

Applicable local building code may require more stringent installation requirements such as, but not limited to, increased fastener or adhesive densities to meet required wind uplift pressures. Consult local building code and uplift requirements prior to any Application of CertainTeed roofing materials. CertainTeed is not responsible for failure to install roofing products per Applicable local building codes.