

SBS-I-3-C

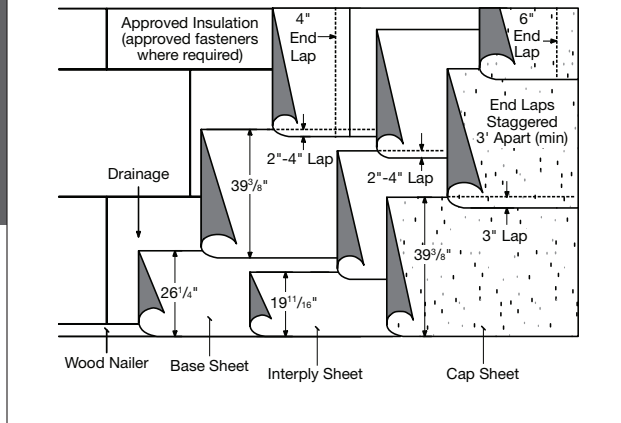

Insulated substrates: base sheet, one interply sheet and an SBS modified cap sheet

SUBSTRATE:

- Steel (Sec. 3.5)
- Concrete (Sec. 3.6-3.9)
- Wood (Sec. 3.10-3.11)
- Poured Gypsum (Sec. 3.12)
- Insulation (Sec. 4.0)
- Re-cover (Sec. 5.0)

MAXIMUM SLOPE:

Up to 6" : 12" (Sec. 15.3)

ROOF ASSEMBLY:

One or more layers of approved insulation and/or coverboard:

- Base layer mechanically attached and additional layers mechanically attached or adhered in hot asphalt or approved adhesive.
- Base layer and additional layers adhered in hot asphalt or approved adhesive.
- Vapor retarder/anchor sheets (Sec. 4.7).

Approved base sheet set in FlintBond® cold process adhesive (Sec. 9.0) or self-adhered (Sec. 10.2).

Approved interply sheet set in FlintBond cold process adhesive (Sec. 9.0) or self-adhered (Sec. 10.2).

Approved cap sheet set in FlintBond cold process adhesive (Sec. 9.0).

SUMMARY OF MATERIALS:

- One or more layers of insulation and/ or coverboard
- Base sheet (1 ply)
- Interply sheet (1 ply)
- Cap sheet (1 ply)
- FlintBond adhesive (three moppings)
(Two moppings if base is self adhered)

APPROVED BASE SHEETS:

(one of the following)

- All Weather/Empire® Base Sheet
- Flintlastic Base 20
- Flintlastic Poly SMS
- Flintlastic Ultra Glass SA (self-adhered)**
- Flintlastic Ultra Poly SMS
- Glasbase™ Base Sheet

APPROVED INTERPLY SHEETS:

(one of the following)

- All Weather/Empire Base Sheet
- Flintlastic Base 20
- Flintlastic Poly SMS
- Flintlastic Ultra Glass SA (self-adhered)******
- Flintlastic Ultra Poly SMS
- Glasbase Base Sheet

APPROVED CAP SHEETS:

(one of the following)

- Flintlastic FR Cap 30*
- Flintlastic FR-P*
- Flintlastic GMS*
- Flintlastic Premium FR-P*

FINAL SURFACING:

For optional surfacing see Section 14.0.

FLASHING ASSEMBLY:

- **Standard.** Over a base sheet or bonded to a primed substrate. One ply Flintlastic modified cap sheet, per CT detail.
- **Premium.** Over a base sheet or bonded to a primed substrate. One smooth and one granulated modified membrane flashing, per CT detail.
- **Premium Alternate.** Over a base sheet or bonded to a primed substrate. One smooth modified membrane and CT SmartFlash®, per CT detail.

Cants: In angles of roof deck and vertical surfaces, the roofing contractor shall furnish and install an approved cant strip with a minimum 3" face.

*Available with CoolStar® reflective granules

**May require torch warming in winter months (Sec. 10.2)

***If not used as base ply

WARRANTY DURATIONS FOR THIS SPECIFICATION VARY BASED ON ROLL MATERIAL SELECTION; SEE WARRANTY MATRIX.

Applicable local building code may require more stringent installation requirements such as, but not limited to, increased fastener or adhesive densities to meet required wind uplift pressures. Consult local building code and uplift requirements prior to any Application of CertainTeed roofing materials. CertainTeed is not responsible for failure to install roofing products per Applicable local building codes.

Consult CertainTeed General Recommendations for noted section references.