

SBS-IN-3-C

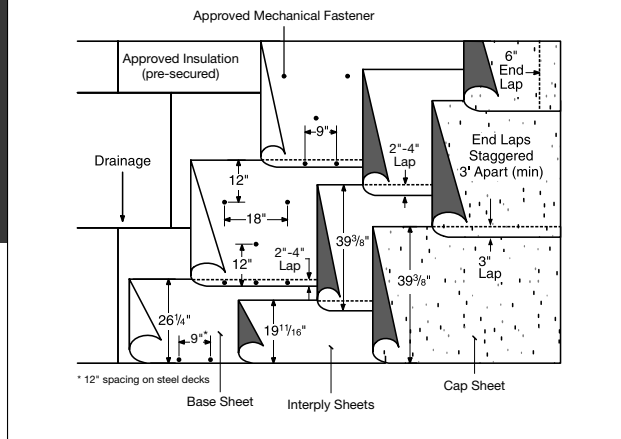

Base sheet mechanically attached through insulated substrate, one interply sheet and an SBS modified cap sheet

SUBSTRATE:

- Steel and nailable (mechanically attached, Sec. 15.4.2)
- Insulation (Sec. 4.0)
- Re-cover (Sec. 5.0)

MAXIMUM SLOPE:

Up to 6" : 12" (Sec. 15.3)

ROOF ASSEMBLY:

One or more layers of approved insulation and/or coverboard:

- Insulation pre-secured with mechanical attachment.

Approved base sheet, mechanically attached with approved screws and plates (Sec. 15.4.2).

Approved interply sheet set in FlintBond® cold process adhesive (Sec. 9.0) or self-adhered (Sec. 10.2).

Approved cap sheet set in FlintBond cold process adhesive (Sec. 9.0).

SUMMARY OF MATERIALS:

- One or more layers of insulation and/ or coverboard
- Base sheet (1 ply)
- Interply sheet (1 ply)
- Cap sheet (1 ply)
- FlintBond adhesive (two moppings)
(One mopping if interply is self-adhered)

APPROVED BASE SHEETS:

(one of the following)

- All Weather/Empire® Base Sheet
- Flexiglas® Base Sheet
- Flintlastic Base 20
- Flintlastic Poly SMS
- Flintlastic Ultra Poly SMS

APPROVED INTERPLY SHEETS:

(one of the following)

- All Weather/Empire Base Sheet
- Flexiglas Base Sheet
- Flintlastic Base 20
- Flintlastic Poly SMS
- Flintlastic Ultra Glass SA (self-adhered)**
- Flintlastic Ultra Poly SMS

APPROVED CAP SHEETS:

(one of the following)

- Flintlastic FR Cap 30*
- Flintlastic FR-P*
- Flintlastic GMS*
- Flintlastic Premium FR-P*

FINAL SURFACING:

For optional surfacing see Section 14.0.

FLASHING ASSEMBLY:

- **Standard.** Over a base sheet or bonded to a primed substrate. One ply Flintlastic modified cap sheet, per CT detail.
- **Premium.** Over a base sheet or bonded to a primed substrate. One smooth and one granulated modified membrane flashing, per CT detail.
- **Premium Alternate.** Over a base sheet or bonded to a primed substrate. One smooth modified membrane and CT SmartFlash®, per CT detail.

Cants: In angles of roof deck and vertical surfaces, the roofing contractor shall furnish and install an approved cant strip with a minimum 3" face.

**Available with CoolStar® reflective granules*

***May require torch warming in winter months (Sec. 10.2)*