



DEPARTMENT OF REGULATORY AND ECONOMIC RESOURCES (RER)  
BOARD AND CODE ADMINISTRATION DIVISION

**NOTICE OF ACCEPTANCE (NOA)**

MIAMI-DADE COUNTY  
PRODUCT CONTROL SECTION  
11805 SW 26 Street, Room 208  
Miami, Florida 33175-2474  
T (786) 315-2590 F (786) 315-2599

[www.miamidade.gov/economy](http://www.miamidade.gov/economy)

**CertainTeed Corporation  
1400 Union Meeting Road  
Blue Bell, PA. 19422**

**SCOPE:**

This NOA is being issued under the applicable rules and regulations governing the use of construction materials. The documentation submitted has been reviewed and accepted by Miami-Dade County RER - Product Control Section to be used in Miami Dade County and other areas where allowed by the Authority Having Jurisdiction (AHJ).

This NOA shall not be valid after the expiration date stated below. The Miami-Dade County Product Control Section (In Miami Dade County) and/or the AHJ (in areas other than Miami Dade County) reserve the right to have this product or material tested for quality assurance purposes. If this product or material fails to perform in the accepted manner, the manufacturer will incur the expense of such testing and the AHJ may immediately revoke, modify, or suspend the use of such product or material within their jurisdiction. RER reserves the right to revoke this acceptance, if it is determined by Miami-Dade County Product Control Section that this product or material fails to meet the requirements of the applicable building code.

This product is approved as described herein, and has been designed to comply with the Florida Building Code including the High Velocity Hurricane Zone of the Florida Building Code.

**DESCRIPTION: Hatteras™, Highland Slate™, and Highland Slate™ IR Shingle**

**LABELING:** Each unit shall bear a permanent label with the manufacturer's name or logo, city, state and following statement: "Miami-Dade County Product Control Approved", unless otherwise noted herein.

**RENEWAL** of this NOA shall be considered after a renewal application has been filed and there has been no change in the applicable building code negatively affecting the performance of this product.

**TERMINATION** of this NOA will occur after the expiration date or if there has been a revision or change in the materials, use, and/or manufacture of the product or process. Misuse of this NOA as an endorsement of any product, for sales, advertising or any other purposes shall automatically terminate this NOA. Failure to comply with any section of this NOA shall be cause for termination and removal of NOA.

**ADVERTISEMENT:** The NOA number preceded by the words Miami-Dade County, Florida, and followed by the expiration date may be displayed in advertising literature. If any portion of the NOA is displayed, then it shall be done in its entirety.

**INSPECTION:** A copy of this entire NOA shall be provided to the user by the manufacturer or its distributors and shall be available for inspection at the job site at the request of the Building Official.

This NOA revises NOA 11-0223.13 and consists of pages 1 through 5.  
The submitted documentation was reviewed by Juan E. Collao, R.A.



NOA No.: 14-0722.18  
Expiration Date: 07/26/16  
Approval Date: 02/19/15  
Page 1 of 5

**ROOFING ASSEMBLY APPROVAL**

**Category:** Roofing  
**Sub-Category:** Asphalt Shingles  
**Materials:** Laminate  
**Deck Type:** Wood

**SCOPE**

This approves **Hatteras™, Highland Slate™, and Highland Slate™ IR Shingles** manufactured by CertainTeed Corporation as described in Section 2 of this Notice of Acceptance, and designed to comply with the High Velocity Hurricane Zone of the Florida Building Code.

**PRODUCT DESCRIPTION**

<u>Product</u>	<u>Dimensions</u>	<u>Test Specifications</u>	<u>Product Description</u>
Hatteras™ Shingle	18” x 36”	TAS 110	A heavy weight, fiberglass reinforced four tab asphalt roof shingle.
Highland Slate™ Shingle	18” x 36”	TAS 110	A heavy weight, fiberglass reinforced four tab asphalt roof shingle.
Highland Slate™ IR Shingle	18” x 36”	TAS 110	A heavy weight, fiberglass reinforced four tab asphalt roof shingle.

**MANUFACTURING LOCATION**

- Oxford, NC

**EVIDENCE SUBMITTED**

<u>Test Agency</u>	<u>Test Identifier</u>	<u>Test Name/Report</u>	<u>Date</u>
Architectural Testing, Inc.	ATI-20134	TAS 100	02/11/98
Underwriters Laboratories, Inc.	94NK9632	TAS 107	05/15/98
	021306-R684A-1	ASTM D 3462	02/13/06
	10CA41303	ASTM D 3462	10/08/10
	10CA41303	TAS 107	10/08/10
	4786334448	ASTM D 3462	06/06/14
	4786334448	TAS 107	02/05/15
PRI Construction Materials Technologies	TFWZ.R684	Fire Classification	12/19/14
	CTC-065-02-01	TAS 100	10/28/10
	CTC-211-02-01	TAS 100	07/07/14
	Letter	TAS 100	02/04/15



**NOA No.: 14-0722.18**  
**Expiration Date: 07/26/16**  
**Approval Date: 02/19/15**  
**Page 2 of 5**

## LIMITATIONS

1. Fire classification is not part of this acceptance; refer to a current Approved Roofing Materials Directory for fire ratings of this product.
2. Shall not be installed on roof mean heights in excess of 33 ft.
3. All products listed herein shall have a quality assurance audit in accordance with the Florida Building Code and Rule 61G20-3 of the Florida Administrative Code.

## INSTALLATION

1. Shingles shall be installed in compliance with Roofing Application Standard RAS 115.
2. Flashing shall be in accordance with Roofing Application Standard RAS 115
3. The manufacturer shall provide clearly written application instructions.
4. Exposure and course layout shall be in compliance with Detail 'A', attached.
5. Nailing shall be in compliance with Detail 'B', attached.

## LABELING

Shingles shall bear the imprint or identifiable marking of the manufacturer's name or logo, city and state of manufacturing facility, and following statement: "Miami-Dade County Product Control Approved" or the Miami-Dade County Product Control Seal as shown below.



## BUILDING PERMIT REQUIREMENTS

1. Application for building permit shall be accompanied by copies of the following:
  - 1.1 This Notice of Acceptance.
  - 1.2 Any other documents required by the Building Official or the applicable code in order to properly evaluate the installation of this system.



NOA No.: 14-0722.18  
Expiration Date: 07/26/16  
Approval Date: 02/19/15  
Page 3 of 5

# DETAIL A COURSE LAYOUT

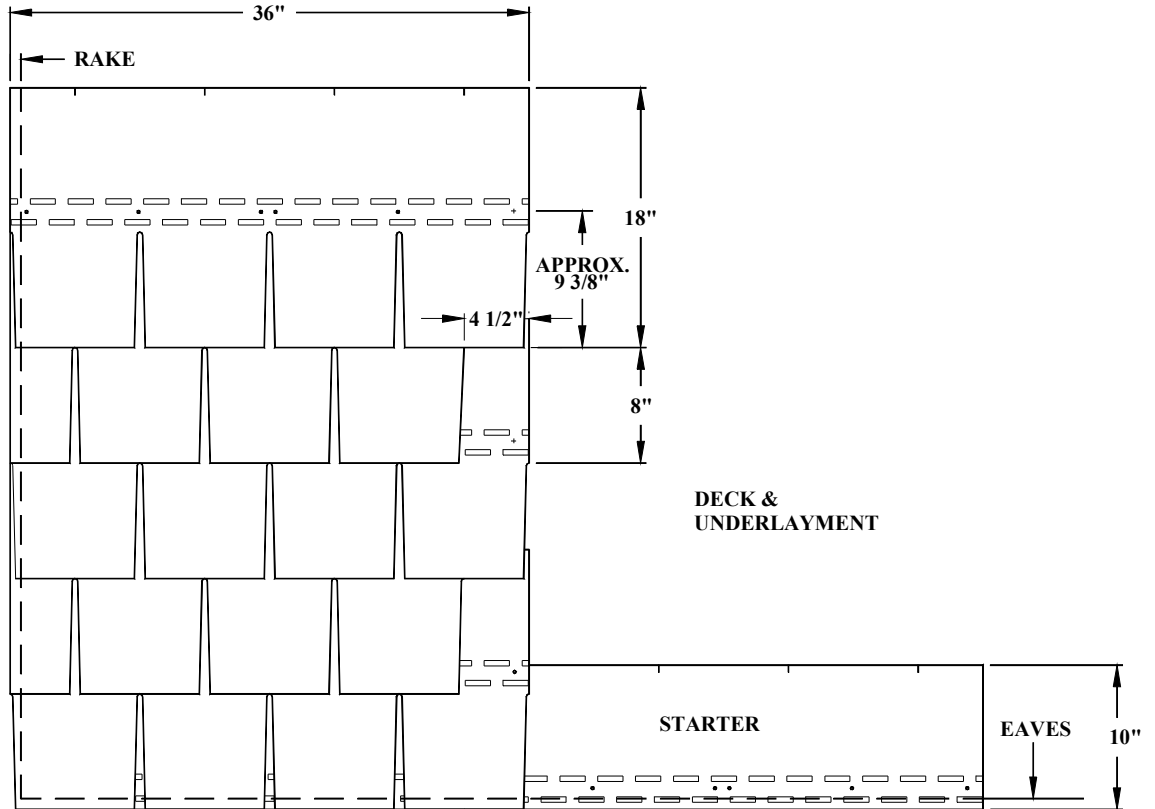

**DETAIL B  
OVERALL DIMENSIONS AND NAILING PATTERN**

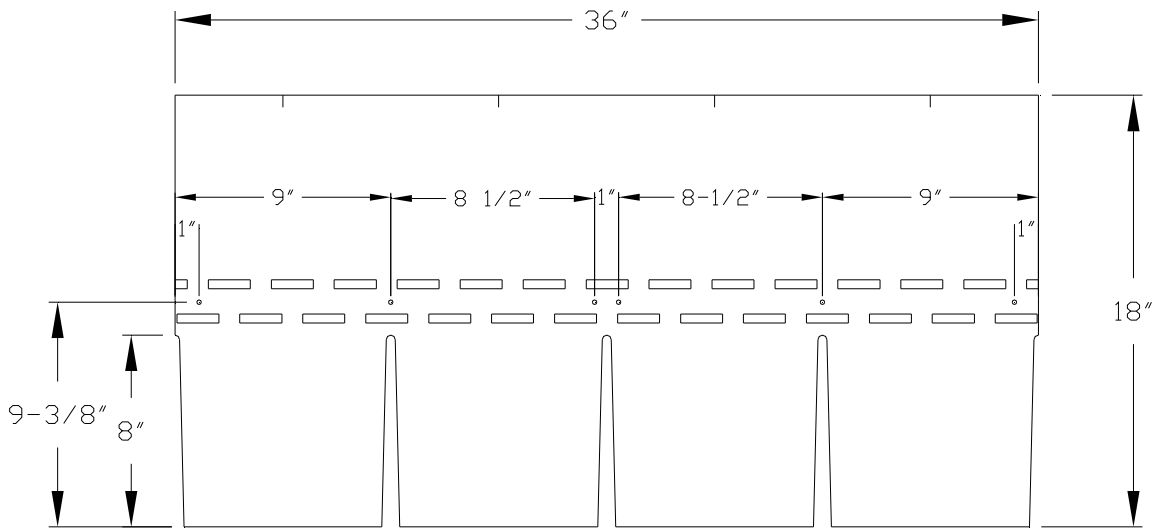

**HATTERAS™ SHINGLE**

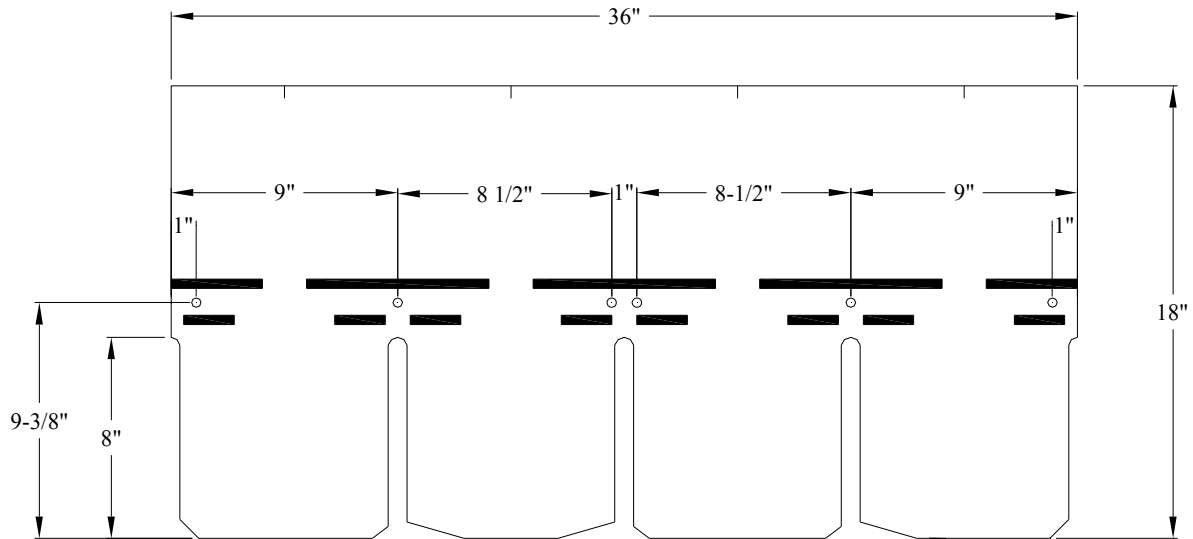

**HIGHLAND SLATE™ & HIGHLAND SLATE™ IR SHINGLES**

**END OF THIS ACCEPTANCE**



NOA No.: 14-0722.18  
Expiration Date: 07/26/16  
Approval Date: 02/19/15  
Page 5 of 5