

**Anchor, Base Ply and Cap Sheet**

Mechanically attach or fully adhere (self-adhered, torch, cold process or hot asphalt) to base of penetration. Proper attachment is defined by specific system, product selection and deck type.

**Tape (Recommended)**

Tape off desired edges for clean detail aesthetic.

**Polyester Reinforcement Preparation (Recommended)**

Prepare reinforcements prior to applying any resin. Door sill flashing requires 6" flashing strips cut to manageable lengths equal to the linear feet of sill length and 8" minimum vertical flashing on the left and right vertical surfaces of the door frame. Overlap reinforcement by 2" (50 mm) anywhere an overlap occurs.

**First Waterproofing Coat**

Using a brush, roller or trowel for resin application. Apply approximately 30 mils of wet resin to the Cap Sheet, approximately 4" (100 mm) out onto the horizontal surface, and vertical rise to sill, minimum 1" beyond where subsequent metal counterflashing terminates. Immediately lightly press reinforcement into wet resin; saturate and fully coat field and vertical reinforcement with resin. Allow to dry 2-3 hours (assumes 70°F or 20°C).

**Second Waterproofing Coat**

Apply approximately 30 mils of wet resin to entire surface covered by first coat.

**Granules (Optional)**

If desired, broadcast granules into the second waterproofing coat before it forms a skin.

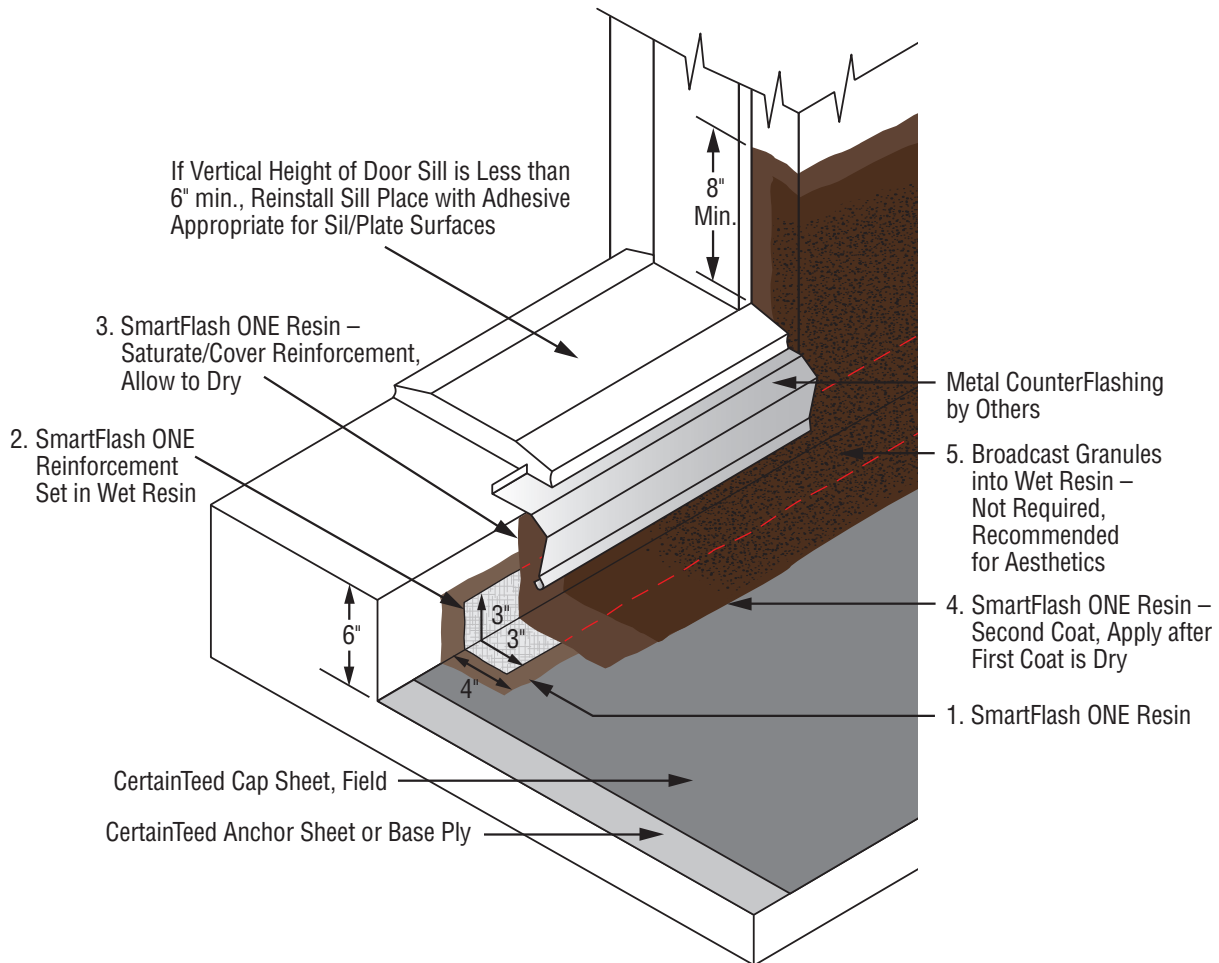

NOT DRAWN TO SCALE