

Anchor, Base Ply and Cap Sheet

Mechanically attach or fully adhere (self-adhered, torch, cold process or hot asphalt) to intersection of horizontal roof plane and wall, extending into the scupper on the horizontal plane of the roof. Proper attachment is defined by specific system, product selection and deck type.

Tape (Recommended)

Tape off desired edges for clean detail aesthetic.

Polyester Reinforcement Preparation (Recommended)

Prepare SmartFlash ONE Reinforcements prior to applying any resin. Cut 6" width SmartFlash ONE Reinforcement to appropriate lengths. Reinforcement shall be applied wherever a change in angle occurs and across any seams in the substrate. Reinforcement shall overlap 2" anywhere an overlap occurs. NOTE: To accommodate inside or outside corners, make a 3" long cut halfway through the width of the strip end.

OUTSIDE CORNERS: The cut allows the strip to round the corner and extend onto the field; a second strip cut the same way shall overlap the first strip.

INSIDE CORNERS: The cut allows the strip to round the corner and overlap itself on the vertical surface; a second strip cut the same way shall overlap the first strip.

First Waterproofing Coat

Using a paint brush, roller or trowel for resin application, apply approximately 30 mils of wet resin to the Cap Sheet approximately 4" (100 mm) horizontally onto the field and vertically passed the scupper flange a minimum of 7".

Immediately lightly press SmartFlash ONE Reinforcement into wet resin:

- A. Base** - where field of roof meets the base of the vertical surface; scupper floor should be self-sealed (metal) but reinforcement can be added for extra protection
- B. Scupper Sides** - vertical edges where the scupper meets the parapet wall
- C. Scupper Flange** - extending 3" onto the flange and 3" onto the parapet wall Saturate and coat Reinforcement with resin such that no Reinforcement is visible. Allow to dry 2-3 hours (assumes 70°F or 20°C).

Second Waterproofing Coat

Apply approximately 30 mils of wet resin to entire surface covered by first coat.

Granules (Optional)

If desired, broadcast granules into the second waterproofing coat before it forms a skin.

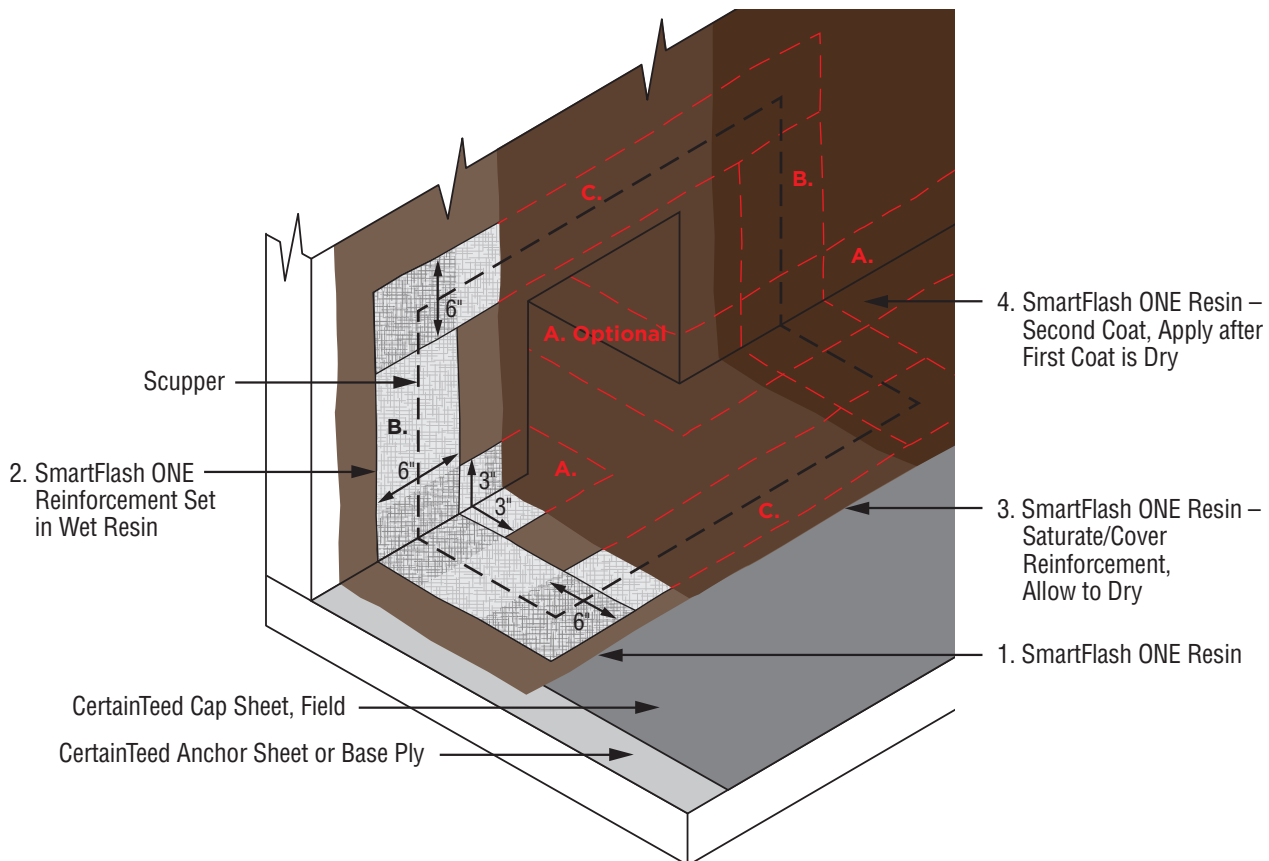

NOT DRAWN TO SCALE