

# CertainTeed

## NO-COAT®

### Drywall Corner

The NO-COAT® Structural Laminate (SLAM®) design represents a revolutionary drywall corner system that provides superior strength and durability, installs faster, and delivers bottom line savings in labor.

Mud applied, extra tough drywall corners that withstand severe impacts and settling. Won't blister, bubble or edge crack. Available in Outside and Inside 90°, Bullnose, L-Trim and Arch profiles.

- High-strength, tapered copolymer core
- Severe impact resistance, will not dent
- Corners will not separate from wall
- Crisp sharp lines without ridges
- Withstands significant shifting due to lumber drying, settling, humidity and temperature differences
- Surface paper is perfect for applying paint and textures



Made With  
**SLAM**  
TECHNOLOGY®

### Strong, Straight Edges

- Outside 90 has a specially engineered profile that makes the boxing of the bead easier and faster
- Bullnose has a ridgeless radius that offers an easily paintable paper face that won't chip or crack and is scratch resistant
- L-Trim requires no masking, allowing for a quick and clean finishing of exposed drywall edges and reveals for a perfect edge
- Arch beads conform to the radius to create a perfectly smooth and rounded corner without the need for glues or staples for installation

### Product Data

DESCRIPTION:		CERTAINTEED CODE:	CARTON CODE:	PACKAGE SIZE:
NO-COAT Outside 90°	8'	318070	10800805180702	50 Sticks/ Carton
NO-COAT Outside 90°	9'	318071	10800805180719	50 Sticks/ Carton
NO-COAT Outside 90°	10'	318072	10800805180726	50 Sticks/ Carton
NO-COAT Outside 90°	12'	318073	10800805180733	50 Sticks/ Carton
NO-COAT Inside 90°	8'	318066	10800805180665	50 Sticks/ Carton
NO-COAT Inside 90°	9'	318067	10800805180672	50 Sticks/ Carton
NO-COAT Inside 90°	10'	318068	10800805180689	50 Sticks/ Carton
NO-COAT Bullnose 3/8"	8'	313042	10800805130424	50 Sticks/ Carton
NO-COAT Bullnose 3/8"	9'	313043	10800805130431	50 Sticks/ Carton
NO-COAT Bullnose 3/8"	10'	313044	10800805130448	50 Sticks/ Carton
NO-COAT Bullnose 3/4"	8'	318062	10800805180627	50 Sticks/ Carton
NO-COAT Bullnose 3/4"	9'	318063	10800805180634	50 Sticks/ Carton
NO-COAT Bullnose 3/4"	10'	318064	10800805180641	50 Sticks/ Carton
NO-COAT L-Trim 1/2"	10'	318077	10800805180771	50 Sticks/ Carton
NO-COAT L-Trim 5/8"	10'	318079	10800805180795	50 Sticks/ Carton
NO-COAT Arch 3/4" Bullnose	10'	313039	10800805130394	10 Sticks/ Carton
NO-COAT Arch Outside 90°	10'	318051	10800805180511	10 Sticks/ Carton

Distributed by:

**CertainTeed**  
SAINT-GOBAIN

Gypsum



### Slam<sup>®</sup> Design Integrates New Technologies and Materials that Outperform All Others.

#### Outside 90

When installing drywall for 90° corners, hang Outside 90 as shown in Figure 1a.

Figure 1a

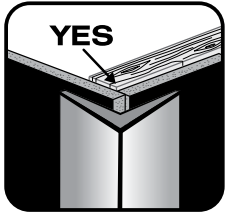
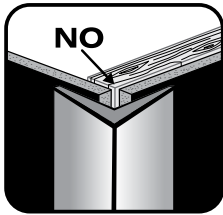

Figure 1b



#### Bullnose

When installing drywall for Bullnose corners, hang as shown in Figure 2a, creating an open area for the radius of the bead. Ensure that drywall at the corners do not touch as shown in Figure 2b.

Figure 2a

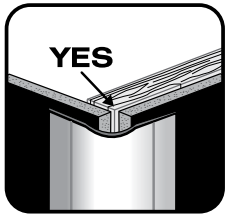
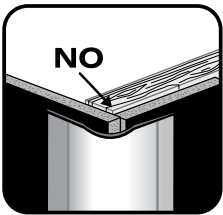
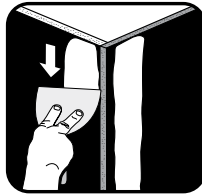

Figure 2b



Made With  
**SLAM**  
TECHNOLOGY<sup>®</sup>

#### Outside 90 and Bullnose



1. Using the tapping knife, apply joint compound to drywall, slightly beyond where the edge of the corner will be. Or use hopper to fill bead.

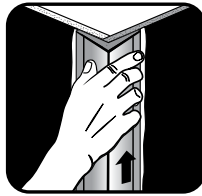

2. Place corner trim on wall, ensuring it is aligned tightly to the ceiling. Press into position.

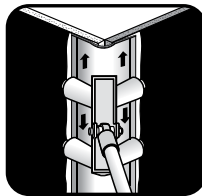

3. Use the roller to embed the trim. Or embed using even pressure, running the knife over it at a 45° angle. Use the tapping knife to skim over the edge with joint compound. Let dry thoroughly.

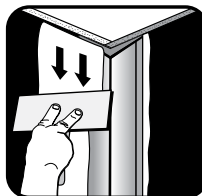

4. Use the wider finishing knife to skim over the edge again. Let dry thoroughly. Lightly sand and paint.

#### L-Trim

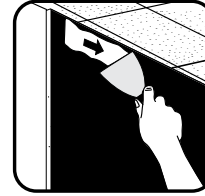

1. Use the tapping knife to apply joint compound to drywall, slightly beyond where the L-Trim will be. Or use hopper to fill bead.

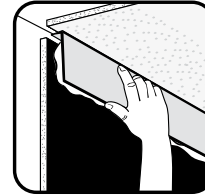

2. Place L-Trim on wall. Press into position

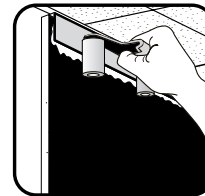

3. Use the roller to embed the trim or embed with a knife, using even pressure running at a 45° angle. Use the tapping knife to skim over the L-Trim edge with joint compound. Let dry thoroughly.

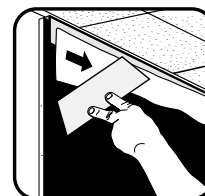

4. Use the wider finishing knife to skim over the L-Trim edge again. Let dry thoroughly. Lightly sand and paint

#### CertainTeed Double Barrel Hopper

For use with NO-COAT inside, outside and bullnose corners and Flexible Corner rolls.

Accommodates all inside and outside angle without time-consuming part changeovers and reconfiguration.

#### Features/Benefits:

- Eliminates part changes or reconfigurations — handles both inside and outside angles.

- Single piece gates with ergonomic hand knob allow for fast and easy adjustments
- High density polyurethane tank and gate controllers
- Stainless steel reservoir trough and gates
- Dimension: 14" x 14" x 13.5"

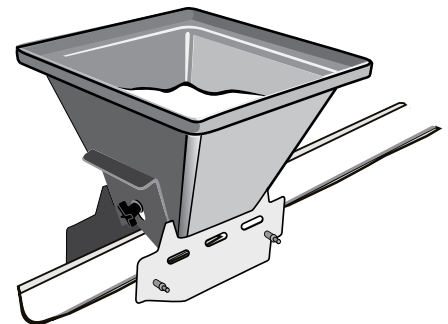

#### ASK ABOUT ALL OF OUR OTHER CERTAINTEED<sup>®</sup> PRODUCTS AND SYSTEMS:

ROOFING • SIDING • TRIM • DECKING • RAILING • FENCE  
GYPSUM • CEILINGS • INSULATION

[www.certainteed.com](http://www.certainteed.com) <http://blog.certainteed.com>

CertainTeed Corporation  
20 Moores Road  
Malvern, PA 19355

Professional: 800-233-8990  
Consumer: 800-782-8777