

NON-INSULATED

INSULATED

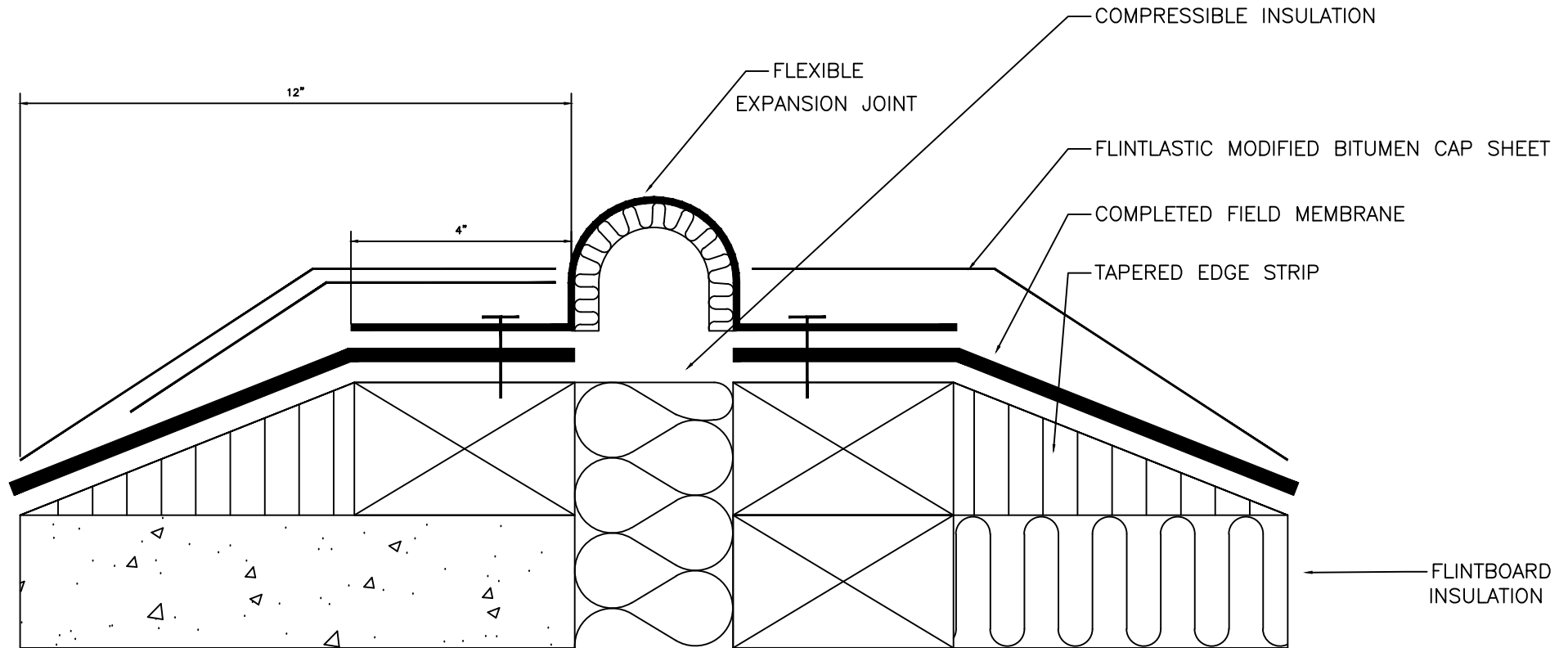

Notes:

1. This detail is appropriate for hot-asphalt, torch-welded, and cold process applications. For self-adhered systems, adapt modifications addressed in Section 5 of Construction Details.
2. Expansion joint flange must be primed, if metal. Nail flange 6" o.c. staggered. End laps shall receive two nails with end laps set in FlintBond or hot asphalt.
3. Seal end laps and terminations of expansion joint according to Manufacturer's specification.

CertainTeed
SAINT-GOBAIN

Commercial Roofing

ISSUE DATE	REVISION	DRAWING NUMBER
10/21/2013	B	CT-18
SCALE		
Not To Scale		Sheet 1 of 1

Flexible Expansion Joint