

SUSPENSION SYSTEMS

15/16" Classic Environmental Stab System



\$\$\$

TOOLS

Visit CertainTeed.com/Ceilings
Download Technical Brochures
LEED® Information / BIM Objects
3-Part Specs / Data Pages

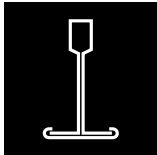

MAIN RUNNER



CROSS TEE



15/16" WALL ANGLE

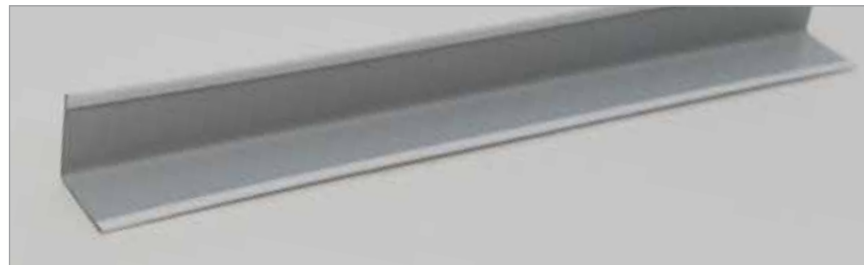
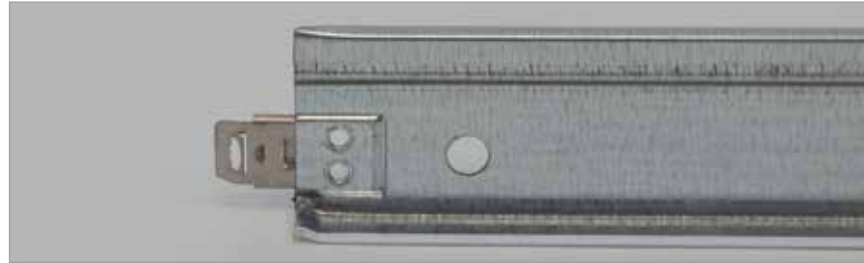

15/16" Wall Angle

The Classic Environmental Stab System is ideal for areas where extreme environments exist, such as parking garages and commercial kitchens.

FEATURES & BENEFITS

- Double web design for lasting durability and strength
- Cross tees are override or stepped end
- Cross tees feature staked-on end tabs for optimal tightness and ease of installation
- Grid features G60 hot-dipped galvanized steel web construction with aluminum capping for high-humidity environments
- Available in white only
- Suitable for all seismic applications
- Seismic compliant per ICC ESR-3336
- High recycled content - 3rd party certified

AVAILABLE EDGE DETAILS

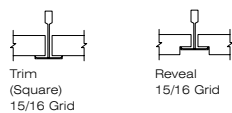

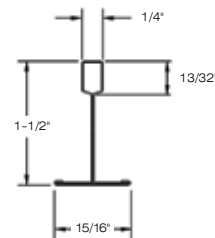

MAIN RUNNERS





ATTRIBUTES

	DESCRIPTION	GRID FACE (INCHES)	DIMENSIONS (INCHES)	SLOT/ROUTE SPACING (INCHES)	STRUCTURAL CLASSIFICATION (ASTM C635)	SEISMIC DESIGN CATEGORY	 RECYCLED CONTENT TOTAL	 RECYCLED CONTENT PRE	 RECYCLED CONTENT POST	PIECES PER CARTON	FEET PER CARTON
15/16" CLASSIC ENVIRONMENTAL STAB SYSTEM											
EVS12-12-15-G60	Main Runner	15/16	144 x 1-1/2 x 15/16	6 O.C.	ID	A-C	56%	25%	31%	20	240
EVS12-12-20-G60	Main Runner	15/16	144 x 1-1/2 x 15/16	6 O.C.	HD	A-F	55%	25%	31%	20	240
EVS2-12-12-G60	Cross Tee	15/16	24 x 1-1/2 x 15/16	—	—	—	55%	24%	31%	60	120
EVS4-12-12-G60	Cross Tee	15/16	48 x 1-1/2 x 15/16	12 O.C.	—	—	55%	24%	31%	60	240
WA15-15SAL	Wall Angle (Aluminum)	15/16	144 x 15/16 x 15/16	—	—	—	88%	19%	69%	40	480

PHYSICAL DATA

Material — Hot dipped galvanized steel (G60)

Face Dimension — 15/16"

Cross Tee/Main runner Interface — Stepped-end/Override

Duty Classification — Heavy-duty or Intermediate duty

Surface Finish — Painted Aluminum Cap

Profile Height — 1-1/2"

End Detail — Main Runner: Integral Stab
Cross Tee: Staked-on Stab Clip

Seismic Rating — Cat. A, B, C, D, E, F

ICC EVALUATION SERVICE, INC., REPORT COMPLIANCE

Suspension systems manufactured by CertainTeed Ceilings have been reviewed and are approved by listing in ICC-ES Evaluation Report ESR-3336. CertainTeed Ceilings suspension systems have been reviewed and are approved by listing in L.A. Research Report number 25978. Evaluation Reports are subject to reexamination, revision and possible cancellation. Refer to CertainTeed.com/Ceilings for current reports.