

SUSPENSION SYSTEMS

15/16" FireSecure™ Stab System



\$\$\$

TOOLS

Visit CertainTeed.com/Ceilings
Download HPDs and EPDs
LEED® Information / BIM Objects
3-Part Specs / Data Pages



MAIN RUNNER



CROSS TEE



15/16" WALL ANGLE



Main Runner



Cross Tee

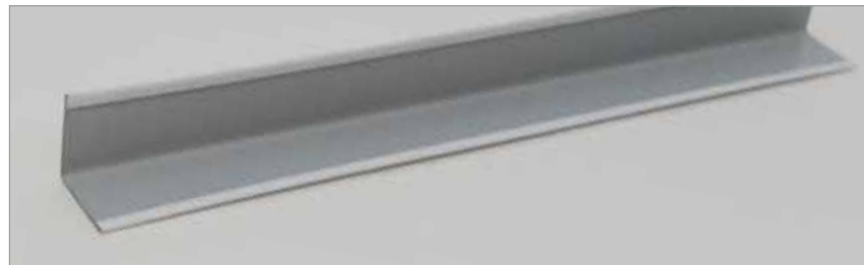

15/16" Wall Angle

The FireSecure™ Stab System features a 15/16" (24 mm) face width that is widely used in interior designs today. The strong integral end tabs provide quick and easy installation with optimal tightness among installed components.

FEATURES & BENEFITS

- The FireSecure™ and Protectone® ceiling assembly offers fire-rated solutions for 2' x 2' and 2' x 4' modules
- Suited for specific UL/ULC time-rated fire-resistant ceiling assemblies
- Tested in accordance with ASTM E119 for fire ratings
- FireSecure™ and Protectone® suspended ceiling designs have been tested and are listed at UL.com and CertainTeed.com/Ceilings
- Suited for seismic categories A-C
- High recycled content - 3rd party certified

AVAILABLE EDGE DETAILS

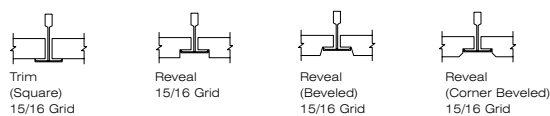

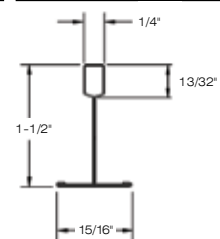

MAIN RUNNERS





ATTRIBUTES

	DESCRIPTION	GRID FACE (INCHES)	DIMENSIONS (INCHES)	SLOT SPACING (INCHES)	STRUCTURAL CLASSIFICATION (ASTM C635)	 RECYCLED CONTENT TOTAL	 RECYCLED CONTENT PRE	 RECYCLED CONTENT POST	PIECES PER CARTON	FEET PER CARTON
15/16" FIRESECURE™ STAB SYSTEM										
FSS-12-12-15	Main Runner	15/16	144 x 1-1/2 x 15/16	6 O.C.	ID	88%	19%	69%	20	240
FSS-2-12-15	Cross Tee	15/16	24 x 1-1/2 x 15/16	—	—	88%	19%	69%	60	120
FSS-4-12-15	Cross Tee	15/16	48 x 1-1/2' x 15/16	12 O.C.	—	88%	19%	69%	60	240
WA15-15	Wall Angle	15/16	144 x 15/16 x 15/16	—	—	88%	19%	69%	40	480