



FINISHING PRODUCTS



Eastern  
Canada

# CertainTeed Finishing Products



CertainTeed is a complete system of finishing products, specially developed to meet the demands of drywall professionals. The result is a professional-grade performance that minimizes callbacks and improves profitability.

CertainTeed packages are colour-coded to make it easy to pick the right CertainTeed product for your application.

## READY-MIXED JOINT COMPOUNDS

CertainTeed Joint Compounds are pre-mixed high performance products designed for professional applicators. These products meet ASTM C475.



### CertainTeed Lite All-Purpose

Code: 639983

17 L / 4.5 US Gal.

- Ready-Mixed Joint Compound
- Designed for fill/finish coats
- Low shrinkage
- Ontario Only



### CertainTeed Lite All-Purpose

Code: 639981

18 L / 4.75 US Gal.

- Ready-Mixed Joint Compound
- Designed for fill/finish coats
- Low shrinkage
- Ontario Only



### CertainTeed Lite Taping

Code: 639985

17 L / 4.5 US Gal.

- Ready-Mixed Joint Compound
- For embedding wallboard tape and trims
- Excellent adhesion
- All regions



### CertainTeed ONE All-Purpose

Code: 639997

17 L / 4.5 US Gal.

- Ready-Mixed Joint Compound
- Superior results for all phases of drywall finishing
- Can be used for skim coating and simple texturing
- All regions



### CertainTeed MACHINE PRO All-Purpose

Code: 640710

17 L / 4.5 US Gal.

- Ready-Mixed Joint Compound
- Optimized for hand taping and automatic taping tools
- Best suited for taping, filling and finishing coats
- All regions



### CertainTeed THE BEST MUD IN THE JOINT\* Light All-Purpose

Code: 639987

17 L / 4.5 US Gal.

- Ready-Mixed Joint Compound
- Designed for fill/finish coats and fastener concealment
- Can be used for skim coating and simple texturing
- Quebec and Atlantic regions



### CertainTeed THE BEST MUD IN THE JOINT\* Light All-Purpose

Code: 640200

17 L / 4.5 US Gal.

- Ready-Mixed Joint Compound
- Designed for fill/finish coats and fastener concealment
- Can be used for skim coating and simple texturing
- Quebec and Atlantic regions

## READY-MIXED JOINT COMPOUNDS

CertainTeed Joint Compounds are pre-mixed high performance products designed for professional applicators. These products meet ASTM C475.



### CertainTeed Dust Away® Renovation Mud\*

**Code: 639993**  
13.5 L / 3.5 US Gal.

- Sanded dust clumps and falls to the floor
- General purpose formula for filling, repairing and finishing
- Ideal for renovations where cleanliness is required
- All regions



### CertainTeed Mould Resistant

**Code: 640030**  
13.5 L / 3.5 US Gal.

- Ready-Mixed Joint Compound
- Designed for tape, fill and finish coats
- Low shrinkage
- All regions



### CertainTeed Heavy Taping

**Code: 640987**  
13.2 L / 3.5 US Gal.

- Ready-Mixed Joint Compound
- Super adhesion to many surfaces
- For embedding wallboard tape and trims
- Central region

## EASI-FIL® RETAIL COMPOUNDS

Easi-Fil® All-Purpose Drywall Compounds are pre-mixed, air drying, easy-to-use products for any drywall job. Use them to embed paper tape, conceal and finish joints, fasteners and trim accessories. Easi-Fil compounds come in varying sizes for any job.



### CertainTeed Easi-Fil® All-Purpose

**Code: 639974** – 2 L / 0.5 US Gal.  
**Code: 639976** – 4.5 L / 1.19 US Gal.  
**Code: 639978** – 12 L / 3.17 US Gal.

- Ready-Mixed Drywall Compound
- Embedding paper tape
- General purpose formula for filling, repairing, and finishing drywall joints, trims and fasteners



### CertainTeed Easi-Fil® Dust AWAY®

**Code: 639995** – 2 L / 0.5 US Gal.  
**Code: 639991** – 4.5 L / 1.19 US Gal.  
**Code: 639989** – 12 L / 3.17 US Gal.

- Ready-Mixed Drywall Compound
- When sanded, dust clumps and falls directly to the floor
- General purpose formula for filling, repairing and finishing drywall joints, trims and fasteners
- Ideal for areas where cleanliness is required

Easi-Fil Setting Powders are chemically setting compounds that set in a prescribed time for fast fills and repairs. They have a higher bond strength than air drying compound.



### CertainTeed Easi-Fil® Light Repair 20

**Code: 640048**  
1.25 kg / 2.76 lb

- Setting Compound
- Embedding mesh tape
- Filling and finishing drywall joints, trims and fasteners
- Easy to sand
- Sets in 20 minutes



### CertainTeed Easi-Fil® Light Repair 90

**Code: 640049**  
1.25 kg / 2.76 lb

- Setting Compound
- Embedding mesh tape
- Filling and finishing drywall joints, trims and fasteners
- Easy to sand
- Sets in 90 minutes



### CertainTeed Easi-Fil® Heavy Repair 90

**Code: 640050**  
2 kg / 4.4 lb

- Setting Compound
- Heavy fills and repairs
- Embedding mesh tape prior to finishing coat
- Hard to sand
- Sets in 90 minutes

## SANDABLE SETTING POWDERS

CertainTeed LITE Sand PLUS Setting Compounds are lightweight sandable chemically setting powders used to prefill joints, embed joint tape and conceal joints, fasteners and trim accessories on gypsum wallboard. They can also be used for interior patching and repair. They are ideal for heavy fills because they are specially formulated to harden with very little shrinkage in a prescribed time frame. Setting times are available from 20 minutes to 90 minutes.



**CertainTeed Lite Sand PLUS**  
**Lite Sand PLUS 20** Code: 640780  
**Lite Sand PLUS 45** Code: 640781  
**Lite Sand PLUS 90** Code: 640782

- 8.1 kg / 18 lb
- Setting Compound
  - Excellent adhesion: ideal for new construction and repair jobs
  - Easy to mix and spread
  - Low shrinkage
  - Sandable



**CertainTeed M2Tech® 90**  
**Code: 640902**

- 8.1 kg / 18 lb
- Setting Compound
  - M2Tech Technology for moisture and mould resistance
  - Lightweight
  - Chemical hardening
  - Low shrinkage
  - Sandable when dry

## HIGH DENSITY 90 SETTING COMPOUND

CertainTeed High Density Setting Compound 90 is recommended for heavy fills or when exceptional bond is necessary. Once dry the product is not easily sanded. It is specially formulated to harden with very little shrinkage. Setting time is 90 minutes.



**CertainTeed High Density 90**  
**Code: 640014**

- 15 kg / 33 lb
- High Strength Setting Compound
  - Non-sandable
  - Low shrinkage
  - Use for embedding tape, heavy fills and repairs
  - Exceptional strength

## JOINT REINFORCEMENT TAPE

CertainTeed Marco® Spark-Perf® Joint Reinforcement Tape is a spark perforated paper tape designed for use with ready-mix joint compound to reinforce gypsum board joints and corners.



**CertainTeed Marco® Spark-Perf® Paper Tape**  
**Code: 642466** - 500' x 10 rolls  
**Code: 642461** - 250' x 20 rolls  
**Code: 642465** - 75' x 20 rolls

- Spark-perforated for elimination of air bubbles
- Manufactured from fibred-paper with added tensile strength to help prevent tearing, wrinkling or stretching
- Machine roughed for superior bonding



**FibaFuse® Paperless Drywall Tape**  
**Code: 406479**  
 2-1/16" x 250'

- Compatible with mould resistant wallboard
- Stronger than paper tape
- Perfect "10" rating on ASTM D3273 mould test
- For use with setting compounds

## WALL AND CEILING SPRAY TEXTURES

CertainTeed Wall and Ceiling Spray Textures provide a decorative appearance over gypsum panels and most other interior wall and ceiling surfaces. They are formulated to provide for a variety of decorative options including splatter, knockdown and orange peel designs.



### **CertainTeed Medium-Tex Spray Texture**

**Code: 640026**

15 kg / 33 lb

- Perlite aggregate based
- Bright white medium texture finish
- Good hide



### **CertainTeed Coarse-Tex Spray Texture**

**Code: 640036**

15 kg / 33 lb

- Polystyrene aggregate based
- Bright white medium texture finish
- Good hide



### **CertainTeed Reinforced Lite Spray Texture**

**Code: 640025**

17 L / 4.5 US Gal.

- Fibre reinforced texture
- Lightweight Ready-Mixed formula
- Suitable for both hand and machine applications

## COATINGS

CertainTeed coatings are high performance surfacers that efficiently bring high levels of finishing.



### **CertainTeed Level V Primer / Surfacers**

**Code: 405374**

18.9 L / 5 US Gal.

- Primer/surfacers for walls and ceilings
- M2Tech Technology for moisture and mould resistance
- Takes a level 4 finish to level 5 finish
- Designed for easy roller or spray application
- Eliminates putty or skim coating by hand
- Can be sanded but not necessary

## PLASTERS

CertainTeed Plaster of Paris is a top quality, quick setting plaster normally used in combination with gauged lime putty to adjust set times and to form plaster mouldings.



### **CertainTeed Plaster of Paris**

**Code: 406478**

20 kg / 44.1 lb

- Fast setting – allows adjustments to the set time of gauged lime putty
- Versatile – can be used in a variety of applications



## Structural Laminate Drywall Corner System

The NO-COAT® Structural Laminate (SLAM®) design represents a revolutionary drywall corner system that provides superior strength and durability, installs faster, and delivers bottom line savings in labour.

NO-COAT structural laminate corners abandon corner bead design entirely. Instead, the SLAM design integrates new technologies and materials like dimensionally extruded copolymer plastic and formulated saturated paper. The result is a corner system that outperforms all others in the market.

### NO-COAT® FLEXIBLE DRYWALL CORNERS

**NO-COAT flex roll products are ideal for off-angle applications, both short and long runs. Wide flange covers large gaps and poor framing. Built-in flexible hinge fits any inside or outside corner angle and creates crisp, straight lines.**

Creating perfect looking corners that will stand the test of time is simple with these two options from CertainTeed. Each one is easy to apply and produces a strong, uniform surface every time. They won't blister, bubble, dent or crack and the surface paper is ideal for applying paint or texture.

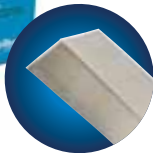

#### CertainTeed NO-COAT® Flexible Corner 325

Code: 639586

100' x 3-1/8" - 10 rolls per case

NO-COAT Flexible Corner 325 offers the same durability and strength as Flexible Corner 450, with a narrower flange width that makes it ideal for shorter off-angle spans.

- Finishes short run off-angles of any length with straight, precise lines
- Built-in flexible hinge forms to any inside or outside corner angle
- Flange width hides irregular framing
- SLAM corner design ensures strength, durability, labour savings and eliminates costly callbacks

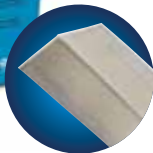

#### CertainTeed NO-COAT® Flexible Corner 450

Code: 639585

100' x 4-1/2" - 4 rolls per case

The world's #1 flex product has earned the reputation for delivering perfectly straight lines for challenging off-angles and long spans, while withstanding settling, shrinking lumber, seismic movements and temperature variations.

- Extra stiff profile provides easy application for long spans
- Wide flange covers large gaps and poor framing
- Built-in flexible hinge adjusts to fit any inside or outside corner angle
- SLAM corner design ensures strength, durability, labour savings and eliminates costly callbacks



SLAM Technology integrates **THREE KEY COMPONENTS** providing the durability, flexibility, and strength that won't crack under pressure.

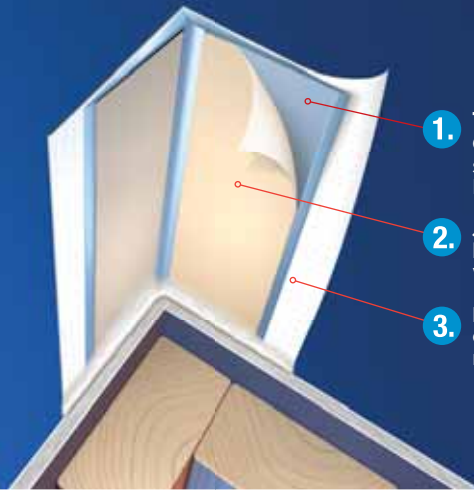

- 1. TAPERED HIGH STRENGTH COPOLYMER CORE** withstands severe impacts. Won't rust. Requires less mud.
- 2. JOINT TAPE** permanently bonds corner to drywall with All Purpose mud.
- 3. FORMULATED SURFACE PAPER** eliminates cracks, chips and peels, resists abrasion, and accepts any finish.

## NO-COAT® DRYWALL CORNER STICKS

Optimal strength and performance for the toughest, straightest edge! NO-COAT mud applied, easy-to-install stick lengths, deliver perfect corners in record time. Apply with CertainTeed tools for high speed installations and flawless results.

Mud applied, extra tough drywall corners that withstand severe impacts and settling. Won't blister, bubble or edge crack. Available in Outside and Inside 90°, 3/8" and 3/4" Bullnose, 1/2" and 5/8" L-Trim and Arch profiles.



### CertainTeed NO-COAT® Outside 90

- Code: 640665 - 8'
- Code: 640666 - 9'
- Code: 640667 - 10'
- Code: 640668 - 12'

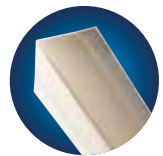

### CertainTeed NO-COAT® Inside 90

- Code: 640661 - 8'
- Code: 640662 - 9'
- Code: 640663 - 10'

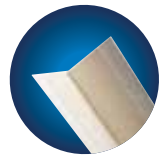

### CertainTeed NO-COAT® Bullnose

- Bullnose 3/8"**
- Code: 639613 - 8'
- Code: 639614 - 9'
- Code: 639615 - 10'
- Code: 640669 - 12'

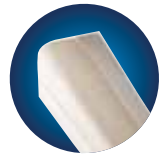

- Bullnose 3/4"**
- Code: 640657 - 8'
- Code: 640658 - 9'
- Code: 640659 - 10'
- Code: 640660 - 12'



### CertainTeed NO-COAT® L-Trim

- L-Trim 1/2"**
- Code: 640670 - 10'
- L-Trim 5/8"**
- Code: 640671 - 10'

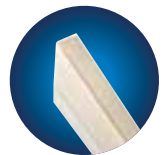

### CertainTeed NO-COAT® Arch

- Arch Bullnose 3/4"**
- Code: 639612 - 10'
- Arch Outside 90°**
- Code: 640655 - 10'



## LEVELLINE® DRYWALL CORNERS

LEVELLINE® flexible rolls are ideal for off-angle applications, both short and long runs. Wide flange covers large gaps and poor framing. The built-in flexible hinge fits any inside or outside corner angle and creates crisp, straight lines.



### CertainTeed LEVELLINE® Flexible Rolls

Code: 640656

100' x 2-3/4" - 12 roll case

- Finishes short runs and off-angles—of less than 10' — with straight, precise lines
- Built-in flexible hinge forms to any inside or outside corner angle
- Flange width hides irregular framing





## AQUABEAD® WATER-ACTIVATED DRYWALL CORNER

**Water-activated AquaBead® offers fast, easy installation and outstanding performance, every time.**

CertainTeed AquaBead corner products are quick and easy — just spray with water and press. No messy compound or spray adhesive required. They can be coated within 30 minutes for quicker finishing. Robust paper-polymer-paper design withstands impacts and movement to prevent dents and edge cracking.



### CertainTeed AquaBead® Outside 90

Code: 639662 - 8'

Code: 639661 - 9'

Code: 639663 - 10'

Code: 639717 - 12'

(12' Available by special order only)

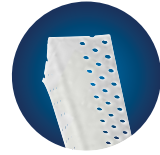

### CertainTeed AquaBead® Bullnose

Code: 639666 - 8'

Code: 639665 - 9'

Code: 639660 - 10'



### CertainTeed AquaBead® L-Trim

L-Trim 1/2"

Code: 639664 - 10'

L-Trim 5/8"

Code: 639872 - 10'



## AquaBead®

- ✓ Water activated adhesive
- ✓ Simple to apply
- ✓ Superior bonding
- ✓ No nails, compound or spray glue required
- ✓ Easy to cut
- ✓ Won't rust or crack
- ✓ Lightweight for easy handling
- ✓ Impact resistant

Just Add  
Water

Specially engineered nose does not require coating. Just fill the outside edges with joint compound to create the perfect corner.

Water-activated adhesive provides a superior bond directly to drywall

Perforations allow compound to adhere to the drywall surface

## DRYWALL CORNER TOOLS

### CertainTeed NO-COAT® Rollers

CertainTeed rollers press corners firmly and accurately into place, creating an absolute bond to the drywall. Drywall corner installations are faster and easier, delivering bottom-line savings on labour and mud.

- Ensures high speed, accurate installations
- Squeezes out excess mud
- Taper matches exact corner profile for the maximum bond with the minimum amount of mud
- Highly durable. Stainless steel components provide extreme corrosion resistance
- Stainless steel rollers with Nylatron and brass bushings
- Stainless steel frame and hardware



### CertainTeed AquaBead® Rollers

CertainTeed AquaBead Rollers allow for high speed installations and flawless results

- Ensures high speed, accurate installations
- Squeezes out excess mud
- Taper matches exact corner profile for the maximum bond with the minimum amount of mud
- Highly durable.



### CertainTeed Double Barrel Hopper™

Works with inside, outside and bullnose stick corners and flexible corners.

**Code: 640676**

- Eliminates part changes or reconfigurations
- Ensures a uniform, high-speed installation
- Single piece gates with ergonomic hand knob allow for fast and easy adjustments
- High density polyurethane tank and gate controllers
- Stainless steel reservoir trough and gates



## GYPSUM COVE, CORNICE AND STEPS

CertainTeed Decorative Moulding is practical, as well as beautiful. It greatly reduces callbacks because CertainTeed eliminates the need to tape and finish wall/ceiling joints — where cracking most often occurs. It can also be used to conceal surface wiring or indirect lighting installations.



### CertainTeed Cove and Cornice Decorative Moulding

#### 3/8" Cove

Code: 405337 - 4-1/2" x 8'

#### 3/8" Cove

Code: 405338 - 4-1/2" x 12'

#### 3/4" Cornice

Code: 405339 - 4-7/16" x 8'

- Interior gypsum board moulding in Cove and Cornice profiles for installation at wall/ceiling intersection.
- Easy to Install using joint compound or caulking adhesive. No screws. No nails. No warping. No splitting.
- Easy to Decorate using the same paint as you do on gypsum board walls and ceilings

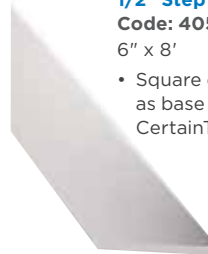

### CertainTeed Steps Decorative Moulding

#### 1/2" Step

Code: 405373

6" x 8'

- Square edge gypsum board used as base steps for the installation of CertainTeed Decorative Moulding.



## TECHNICAL INFORMATION

### Technical References

For additional information on the application and finishing of CertainTeed Joint Compounds please consult:

- ASTM C475: Standard specification for Joint Compound and Joint Tape for Finishing Gypsum Board.
- ASTM C840: Standard Specification for Application and Finishing of Gypsum Board.
- GA-214: Gypsum Association publication "Levels of Gypsum Board Finish."
- GA-216: Gypsum Association publication "Recommended Specifications for the Application and Finishing of Gypsum Board."

### Site Conditions

The room temperature should be maintained at 10°C (50°F) for 48 hours prior to application and continuously thereafter until completely dry. Gypsum wallboard should be dry for at least 48 hours before the application of joint compounds. Continuous ventilation must be provided to ensure proper drying. When using temporary heating, care should be taken to avoid overheating and high humidity.

### Warranty

Since methods and conditions of application such as temperature, humidity and over thinning are beyond our control, CertainTeed Canada, Inc. (CertainTeed) will not be responsible for the failure of this Product when the Product is not used according to directions and specifications and accepted standards of procedure inherent in drywall application; or when reasonable allowance is not made by the user for adverse weather and job conditions. However, if this Product proves to be defective, maximum liability shall be limited to replacement of the material only or refund of the purchase price. This shall be the full limit whatsoever of CertainTeed's liability. All claims shall be submitted in writing to CertainTeed within thirty days from the date of discovery. State/Provincial or Federal laws may provide rights in addition to this warranty that cannot be modified or excluded.

## Gypsum

Every day, walls come under attack – from bumps to mould, formaldehyde to sound transmission. CertainTeed drywall and corner solutions can fend off whatever life throws at it, creating superior durability, acoustic and indoor air quality solutions. See Why Walls Matter, in any project, with CertainTeed Gypsum. [certainteed.ca/wallsmatter](http://certainteed.ca/wallsmatter)

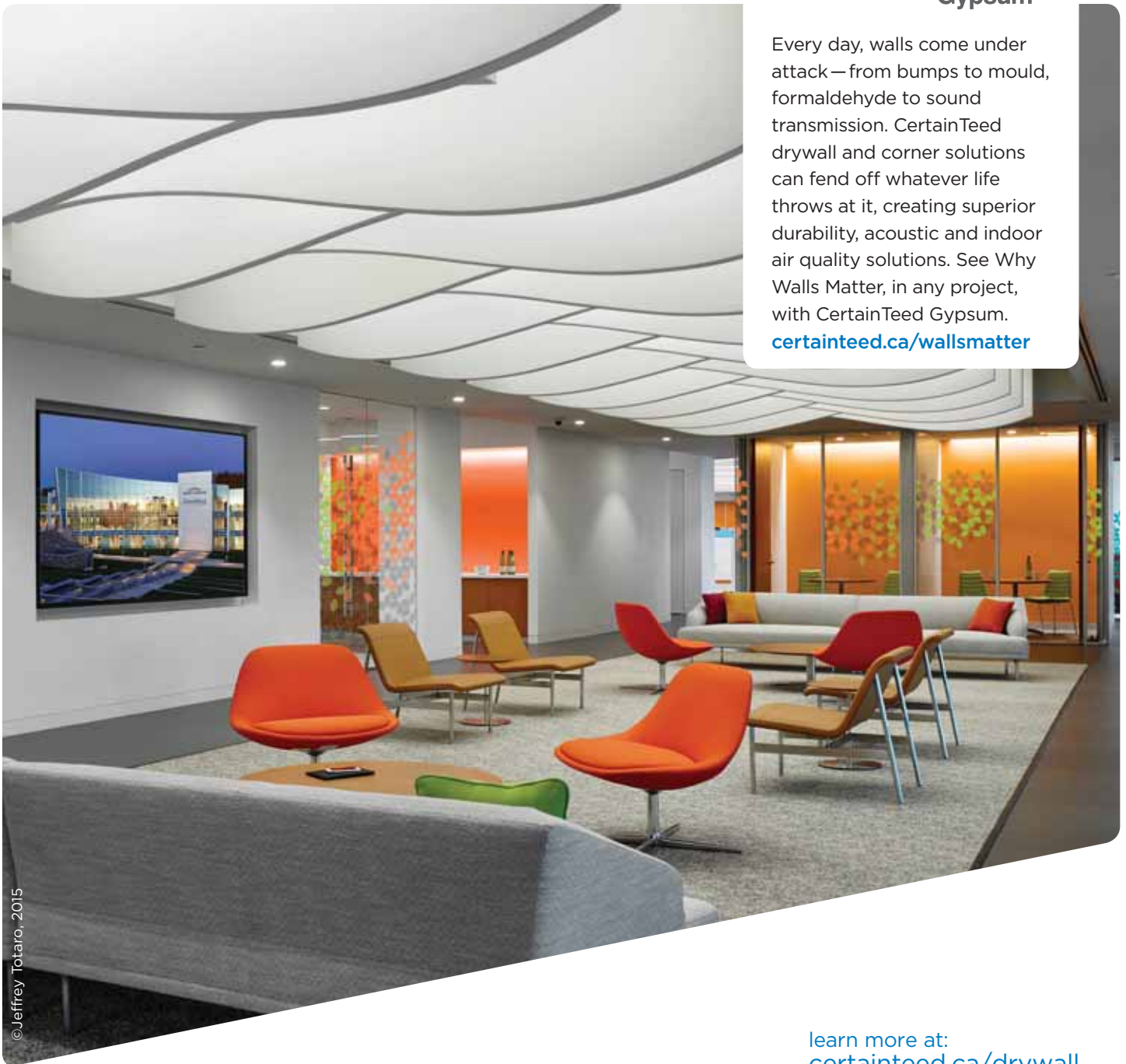

©Jeffrey Totaro, 2015

learn more at:  
[certainteed.ca/drywall](http://certainteed.ca/drywall)



### CertainTeed Corporation

CEILINGS • DECKING • FENCE • GYPSUM • INSULATION • RAILING • ROOFING • SIDING • TRIM

2424 Lakeshore Rd. West, Mississauga, ON L5J 1K4 Professional: 800-233-8990 Consumer: 800-782-8777 [certainteed.ca](http://certainteed.ca)