

# APP-I-3-T

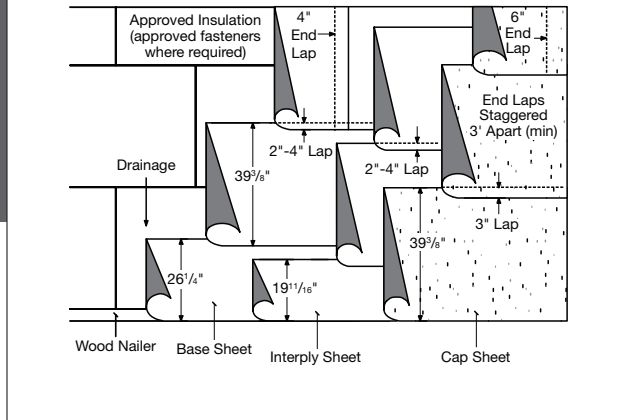

## Insulated substrates: adhered base sheet, adhered interply sheet and torch-welded APP modified cap sheet

### SUBSTRATE:

- Steel (Sec. 3.5)
- Concrete (Sec. 3.6-3.9)
- Wood (Sec. 3.10-3.11)
- Poured Gypsum (Sec. 3.12)
- Insulation (Sec. 4.0)
- Re-cover (Sec. 5.0)

### MAXIMUM SLOPE:

Up to 6": 12" (Sec. 15.3)

### ROOF ASSEMBLY:

One or more layers of approved insulation and/or coverboard:

- Base layer mechanically attached and additional layers mechanically attached or adhered in hot asphalt or approved adhesive.
- Base layer and additional layers adhered in hot asphalt or approved adhesive.
- Vapor retarder/anchor sheets (Sec. 4.7).

Approved base sheet set in hot asphalt (Sec. 7.0), torch-welded (Sec. 8.0), or self-adhered (Sec. 10.2).

Approved interply sheet set in hot asphalt (Sec. 7.0), torch-welded (Sec. 8.0), or self-adhered (Sec. 10.2).

Approved cap sheet, torch-welded (Sec. 8.0).

### SUMMARY OF MATERIALS:

- One or more layers of insulation and/ or coverboard.
- Base sheet (1 ply)
- Interply sheet (1 ply)

WARRANTY DURATIONS FOR THIS SPECIFICATION VARY BASED ON ROLL MATERIAL SELECTION; SEE WARRANTY MATRIX.

Applicable local building code may require more stringent installation requirements such as, but not limited to, increased fastener or adhesive densities to meet required wind uplift pressures. Consult local building code and uplift requirements prior to any application of CertainTeed roofing materials. CertainTeed is not responsible for failure to install roofing products per applicable local building codes.

- Cap sheet (1 ply)
- ASTM D 312 asphalt (two moppings) (No moppings if base is torch-welded or self-adhered)

### APPROVED BASE SHEETS:

(one of the following)

#### Hot Asphalt Applied

- All Weather/Empire® Base Sheet
- Flintlastic Base 20
- Flintlastic Poly SMS
- Flintlastic Ultra Poly SMS
- Glasbase™ Base Sheet
- Yosemite® Venting Base Sheet

#### Torch Welded

- Flintlastic APP Base T
- Flintlastic STA\*\*
- Flintlastic STA Plus\*\*
- Flintlastic Ultra Poly SMS\*\*

#### Self-Adhered

- Black Diamond® Base Sheet
- Flintlastic Ultra Glass SA

### APPROVED INTERPLY SHEETS:

(One of the following)

#### Hot Asphalt Applied

- All Weather/Empire Base Sheet
- Flintglas Ply 4
- Flintglas Premium Ply 6
- Flintlastic Base 20
- Flintlastic Poly SMS
- Flintlastic Ultra Poly SMS
- Glasbase Base Sheet
- Yosemite Venting Base Sheet

### Torch Welded

- Flintlastic APP Base T
- Flintlastic STA
- Flintlastic STA Plus
- Flintlastic Ultra Poly SMS

### Self-Adhered

- Black Diamond Base Sheet\*\*\*
- Flintlastic Ultra Glass SA\*\*\*

### APPROVED CAP SHEETS:

(one of the following)

- Flintlastic GTA\*
- Flintlastic GTA-FR\*
- Flintlastic STA
- Flintlastic STA Plus

### FINAL SURFACING:

For optional surfacing see Section 14.0.

Flintlastic STA and STA Plus (used as cap sheets) require reflective coating.

- FlintCoat A-300 or W (required over Flintlastic STA and STA Plus)

### FLASHING ASSEMBLY:

- **Standard.** Over a base sheet or bonded to a primed substrate. One ply Flintlastic modified cap sheet, per CT detail.
- **Premium.** Over a base sheet or bonded to a primed substrate. One smooth and one granulated modified membrane flashing, per CT detail.
- **Premium Alternate.** Over a base sheet or bonded to a primed substrate. One smooth modified membrane and CT SmartFlash®, per CT detail.

**Asphalt:** Type III or Type IV (Sec. 7.0).

**Cants:** In angles of roof deck and vertical surfaces, the roofing contractor shall furnish and install an approved cant strip with a minimum 3" face.

\* Available with CoolStar® reflective granules

\*\* Over approved gypsum coverboards only

\*\*\* Not approved over Flintlastic APP Base T, Flintlastic STA or Flintlastic STA Plus

Consult CertainTeed General Recommendations for noted section references.

**CertainTeed**  
SAINT-GOBAIN