



DEPARTMENT OF REGULATORY AND ECONOMIC RESOURCES (RER)  
BOARD AND CODE ADMINISTRATION DIVISION

## NOTICE OF ACCEPTANCE (NOA)

MIAMI-DADE COUNTY  
PRODUCT CONTROL SECTION  
11805 SW 26 Street, Room 208  
Miami, Florida 33175-2474  
T (786) 315-2590 F (786) 315-2599  
[www.miamidade.gov/economy](http://www.miamidade.gov/economy)

**Hunter Douglas Arch Products a div. of Hunter Douglas, Inc.**  
5015 Oakbrook Parkway, Suite 100  
Norcross, GA 30093

### SCOPE:

This NOA is being issued under the applicable rules and regulations governing the use of construction materials. The documentation submitted has been reviewed and accepted by Miami-Dade County RER-Product Control Section to be used in Miami Dade County and other areas where allowed by the Authority Having Jurisdiction (AHJ).

This NOA shall not be valid after the expiration date stated below. The Miami-Dade County Product Control Section (In Miami Dade County) and/or the AHJ (in areas other than Miami Dade County) reserve the right to have this product or material tested for quality assurance purposes. If this product or material fails to perform in the accepted manner, the manufacturer will incur the expense of such testing and the AHJ may immediately revoke, modify, or suspend the use of such product or material within their jurisdiction. RER reserves the right to revoke this acceptance, if it is determined by Miami-Dade County Product Control Section that this product or material fails to meet the requirements of the applicable building code.

This product is approved as described herein, and has been designed to comply with the Florida Building Code, including the High Velocity Hurricane Zone.

### DESCRIPTION: 150F Vented Aluminum Exterior Ceiling System

**APPROVAL DOCUMENT:** Drawing No. **150F-B1.0-1.10**, titled "150F Product Specifications", sheets 1 through 10 of 10, dated 11/11/2014, prepared by HDAP Engineering, signed and sealed by Scott Wolters, P.E., bearing the Miami-Dade County Product Control revision stamp with the Notice of Acceptance number and expiration date by the Miami-Dade County Product Control Section.

### MISSILE IMPACT RATING: None

**LABELING:** Each piece shall be permanently marked at not more than 4' o.c. with a number or marking and the packaging shall include the manufacturer's name or logo, city, state, model number or name, Miami-Dade County NOA number, test standards and net free area per FBC 1710.9.2 and 1710.9.3.

**RENEWAL** of this NOA shall be considered after a renewal application has been filed and there has been no change in the applicable building code negatively affecting the performance of this product.

**TERMINATION** of this NOA will occur after the expiration date or if there has been a revision or change in the materials, use, and/or manufacture of the product or process. Misuse of this NOA as an endorsement of any product, for sales, advertising or any other purposes shall automatically terminate this NOA. Failure to comply with any section of this NOA shall be cause for termination and removal of NOA.

**ADVERTISEMENT:** The NOA number preceded by the words Miami-Dade County, Florida, and followed by the expiration date may be displayed in advertising literature. If any portion of the NOA is displayed, then it shall be done in its entirety.

**INSPECTION:** A copy of this entire NOA shall be provided to the user by the manufacturer or its distributors and shall be available for inspection at the job site at the request of the Building Official.

This NOA revises NOA #14-1222.04 and consists of this page 1 and evidence pages E-1 and E-2, as well as approval document mentioned above.

The submitted documentation was reviewed by **Carlos M. Utrera, P.E.**



*Carlos M. Utrera*  
10/27/2017

NOA No. 17-0807.10  
Expiration Date: March 19, 2020  
Approval Date: November 2, 2017  
Page 1

NOTICE OF ACCEPTANCE: EVIDENCE SUBMITTED

1. **EVIDENCE SUBMITTED UNDER NOA #14-1222.04**
- A. **DRAWINGS**
  1. Drawing No. **150F-B1.0-1.10**, titled "150F Product Specifications", sheets 1 through 10 of 10, dated 11/11/2014, prepared by HDAP Engineering, signed and sealed by Scott Wolters, P.E.
- B. **TESTS**
  1. Test reports on 1) Uniform Static Air Pressure Test, Loading per FBC TAS 202-94  
2) Cyclic Wind Pressure Loading per FBC, TAS 203-94  
along with marked-up drawings of 150F (18" Configuration) Soffit System, prepared by Intertek-Architectural Testing, Inc., Test Report No. **D6475.01-550-18**, dated 11/24/2014, with revision 2 dated 12/11/2014, signed and sealed by Shawn G. Collins, P.E.
  2. Test reports on 1) Uniform Static Air Pressure Test, Loading per FBC TAS 202-94  
2) Cyclic Wind Pressure Loading per FBC, TAS 203-94  
along with marked-up drawings of 150F (49" Configuration) Soffit System, prepared by Intertek-Architectural Testing, Inc., Test Report No. **D6475.03-550-18**, dated 11/24/2014, with revision 2 dated 12/11/2014, signed and sealed by Shawn G. Collins, P.E.
  3. Test reports on 1) Uniform Static Air Pressure Test, Loading per FBC TAS 202-94  
2) Cyclic Wind Pressure Loading per FBC, TAS 203-94  
along with marked-up drawings of 150F (16" Configuration) Soffit System, prepared by Intertek-Architectural Testing, Inc., Test Report No. **D6475.04-550-18**, dated 11/24/2014, with revision 2 dated 12/11/2014, signed and sealed by Shawn G. Collins, P.E.
  4. Test report on Wind Driven Rain Resistance Test per FBC, TAS 100(A)-95 of 150F Vented Soffit, prepared by Intertek-Architectural Testing, Inc., Test Report No. **D6475.05-109-18**, dated 11/24/2014, signed and sealed by Michael D. Stremmel, P.E.
  5. Test report on Tensile Test per ASTM E8 of 150F Soffit Aluminum, prepared by Intertek-Architectural Testing, Inc., Test Report No. **D6475.07-106-18**, dated 12/04/2014, signed and sealed by Gary T. Hartman, P.E.
- C. **CALCULATIONS**
  1. Structural and anchorage calculations prepared by Wolters Engineering, Inc., dated 12/18/2014, signed and sealed by Scott Wolters, P.E.
- D. **QUALITY ASSURANCE**
  1. Miami-Dade Department of Regulatory and Economic Resources (RER)
- E. **MATERIAL CERTIFICATIONS**
  1. None.
- F. **STATEMENTS**
  1. Statement letter of code conformance to 2010 and 5<sup>th</sup> edition (2014) FBC issued by Wolters Engineering, Inc., dated 03/11/2015, signed and sealed by Scott Wolters, P.E.
  2. Statement letter of no financial interest issued by Wolters Engineering, Inc., dated 12/18/2014, signed and sealed by Scott Wolters, P.E.

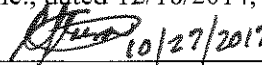
  
\_\_\_\_\_  
Carlos M. Utrera, P.E.

Product Control Examiner

NOA No. 17-0807.10

Expiration Date: March 19, 2020

Approval Date: November 2, 2017

NOTICE OF ACCEPTANCE: EVIDENCE SUBMITTED

2. NEW EVIDENCE SUBMITTED

A. DRAWINGS

1. None.

B. TESTS

1. None.

C. CALCULATIONS

1. None.

D. QUALITY ASSURANCE

1. Miami-Dade Department of Regulatory and Economic Resources (RER)

E. MATERIAL CERTIFICATIONS

1. None.

F. STATEMENTS

1. None.

G. OTHERS

1. Company name change request correspondence.



10/27/2017

---

Carlos M. Utrera, P.E.  
Product Control Examiner  
NOA No. 17-0807.10  
Expiration Date: March 19, 2020  
Approval Date: November 2, 2017

NOTE: FOR DESIGN WIND PRESSURE(S), SEE TABLE 1 ON SHEET 3

**PRODUCT REVISED**  
 as complying with the Florida Building Code  
 NOA-No. **17-0807.10**  
 Expiration Date **03/19/2020**  
 By *[Signature]*  
 Miami-Dade Product Control

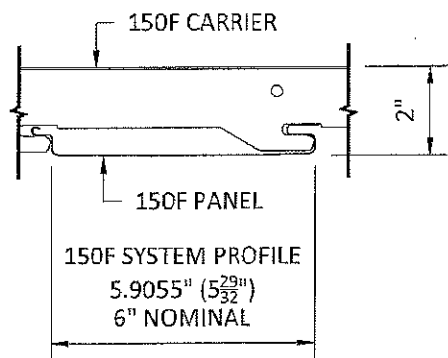

**A**  
**1** TYPICAL SECTION  
 SCALE: 3" = 1'-0"

CARRIER SPAN VARIES DEPENDING ON DESIGN WIND PRESSURE SEE DETAIL B.12

SUSPENSION REQUIREMENTS SEE SHEET 3

PANEL SPLICE SEE SHEET 5

CARRIER SPLICE SEE SHEET 5

6" MAX CARRIER OVERHANG

12 GA HANGER WIRE WITHIN 3" OF VERTICAL SUPPORT

12 GA HANGER WIRE SEE SHEET 3

TYPICAL SYSTEM SECTION SEE DETAIL A/1

VERTICAL SUPPORT SEE SHEET 4

150F PANEL SEE SHEET 2

1" WALL ANGLE SEE SHEET 6

PANEL SPAN VARIES DEPENDING ON DESIGN WIND PRESSURE SEE SHEET 3

PANEL LENGTH 3'-0" MIN - 20'-0" MAX

PANEL WIDTH 5.9055" (5-29/32") 6" NOMINAL

PANEL OVERHANG 6" MAX

SEE SHEETS 8 THRU 10 FOR FIXTURE OPENING RECOMMENDATIONS

**GENERAL NOTES:**

1. THIS SOFFIT SYSTEM HAS BEEN DESIGNED AND TESTED IN ACCORDANCE WITH THE REQUIREMENTS OF THE FLORIDA BUILDING CODE 5TH EDITION (2014), INCLUDING THE HVHZ PROVISIONS.
2. ANCHOR TYPE, SIZE, SPACING, AND EMBEDMENT SHALL BE AS SPECIFIED IN THESE DRAWINGS. ANCHOR EMBEDMENT TO SUBSTRATE SHALL BE BEYOND WALL DRESSING OR STUCCO.
3. ALL FASTENERS PENETRATING INTO PRESSURE TREATED WOOD SHALL BE CAPABLE OF PREVENTING CORROSION DUE TO REACTION WITH PRESSURE TREATMENT CHEMICALS.
4. DISSIMILAR MATERIALS THAT COME INTO CONTACT SHALL BE PROTECTED TO PREVENT REACTIONS IN ACCORDANCE WITH FBC AND ADM-01-2010 SECTION M7.
5. A WINDLOAD DURATION FACTOR (Cd) OF 1.6 WAS USED FOR ANALYSIS OF WOOD SCREWS ONLY. THE 1/3 INCREASE IN ALLOWABLE STRESS FOR WIND DESIGN WAS NOT USED.

Approved as complying with the Florida Building Code  
 Date **03/19/2015**  
 NOA# **14-1222-04**  
 Miami Dade Product Control  
 By *[Signature]*

SCOTT WALTERS  
 FL PE# 62354

SEAL: *[Signature]*

WALTERS ENGINEERING  
 (COA# 27194)  
 15211 97TH ROAD N  
 WEST PALM BEACH, FL 33412  
 PH/FAX: (561) 225-1982

DEC 18 2014

**EXTERIOR INSTALLATION**

**HUNTER DOUGLAS ARCHITECTURAL PRODUCTS**

5015 Oakbrook Parkway, Suite 100  
 Norcross, GA 30093  
 800-366-4327 / 770-806-9557  
 Fax: 770-806-0214

www.hunterdouglascontract.com

**SPECIFICATIONS**  
 (unless noted otherwise)

MATERIAL: 150F PANEL: .025" ALUMINUM ALLOY 3005-H48  
 150F CARRIER: 0.040" ALUMINUM ALLOY 5050-H48  
 FINISHES: PAINT / POWDER COAT / DECORATED WOOD FINISH / LUXACOTE  
 PERFORATION: #124 (15% OPEN)

**TOLERANCES**  
 (unless noted otherwise)

DECIMAL: .0 +/- .060  
 .00 +/- .030  
 .000 +/- .010  
 FRACTIONAL: +/- 1/32"  
 ANGULAR: +/- 1/2° (.5°)

**OVERALL ISOMETRIC VIEW**

PROJECT: 150F PRODUCT SPECIFICATIONS  
 DRAWING NUMBER: 150F-B1.0  
 PART NUMBER: N/A  
 SCALE: 3" = 1'-0"  
 DATE: 11/11/14  
 DRAWN BY: HDAP ENGINEERING

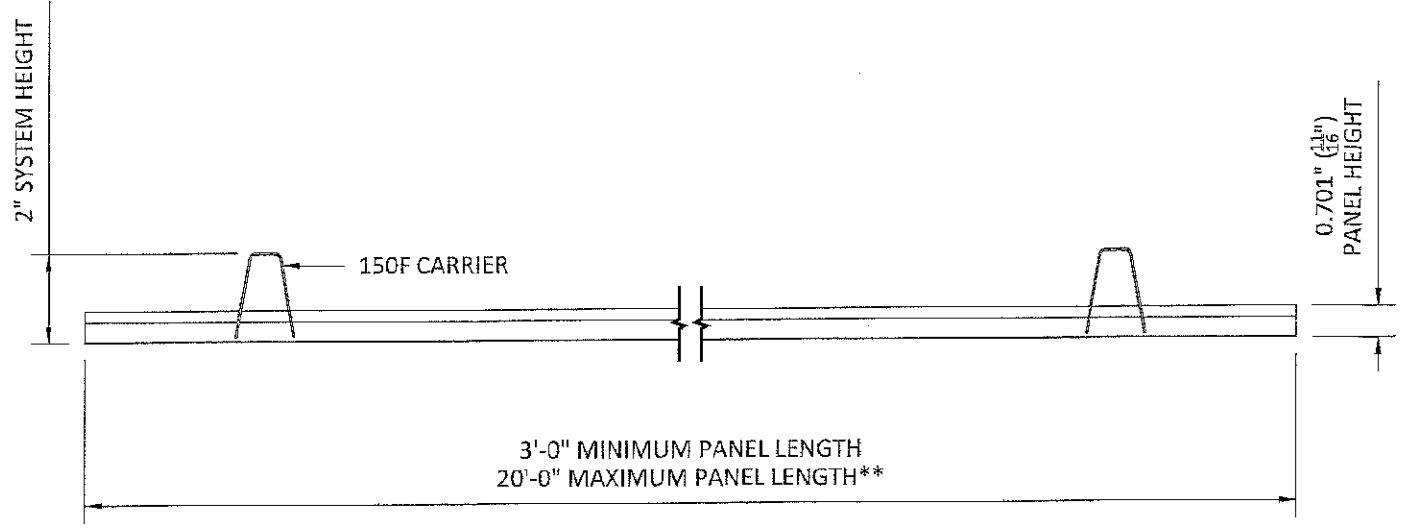

**FACTORY SIDE PANEL VIEW**  
SCALE: 3" = 1'-0"

\*VERTICAL SUPPORT OMITTED FOR CLARITY  
\*\*PANEL LENGTHS VARIABLE IN  $\frac{1}{8}$ " (.125") INCREMENTS, TOLERANCE  $\pm \frac{1}{8}$ "

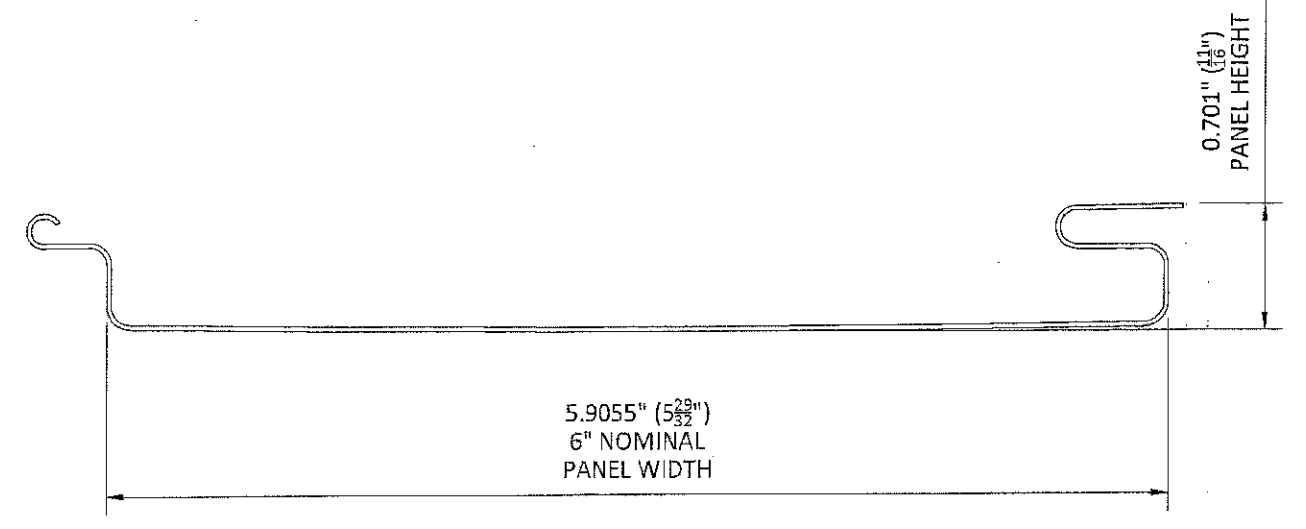

**FACTORY END PANEL VIEW**  
SCALE: FULL

\*SUSPENSION OMITTED FOR CLARITY

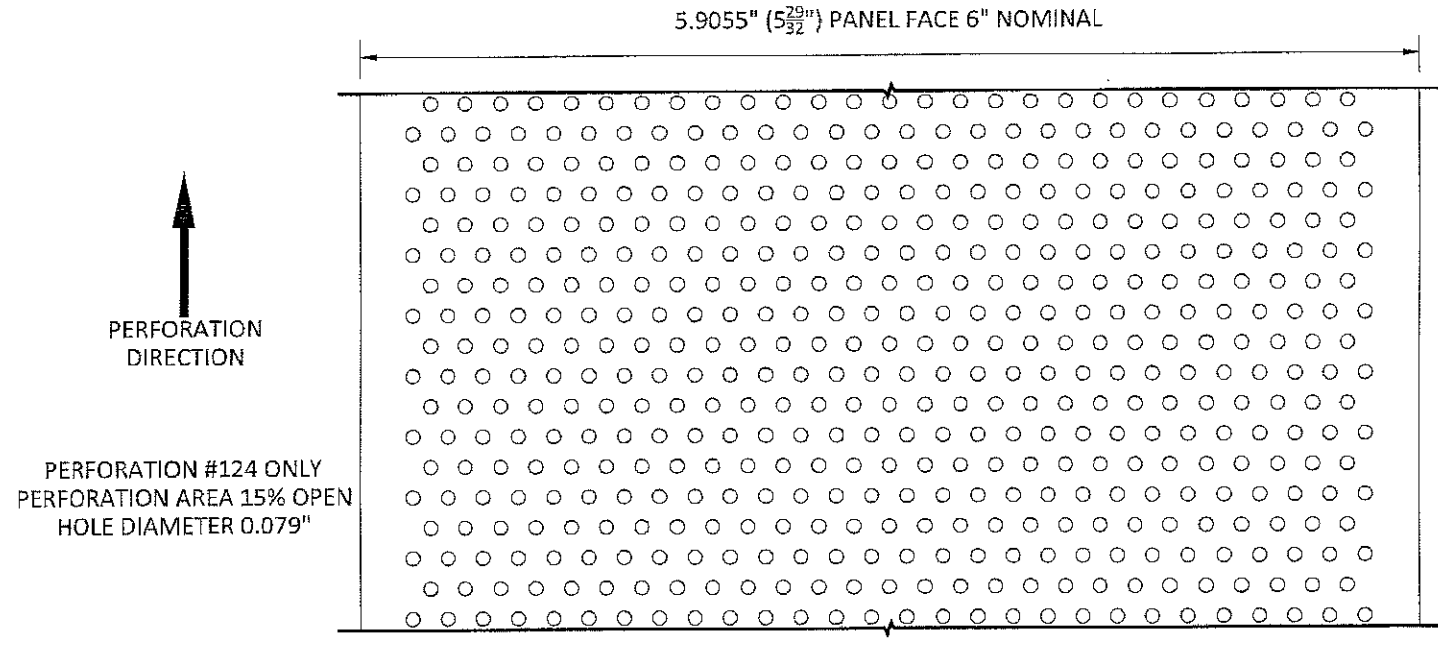

**AVAILABLE PERFORATION**  
SCALE: FULL

PERFORATION #124 ONLY  
PERFORATION AREA 15% OPEN  
HOLE DIAMETER 0.079"

**150F PANEL MATERIAL THICKNESS**  
.025" ALUMINUM ALLOY 3005-H48

**150F PANEL FINISHES**

PAINTED & POWDER COATED - INTERIOR & EXTERIOR

LUXACOTE - INTERIOR & EXTERIOR

DECORATED WOOD FINISH (POWDER COATED) - INTERIOR & EXTERIOR

**PRODUCT REVISED**  
as complying with the Florida Building Code  
Date 03/19/2015  
NOA-No. 17-0807.10  
Expiration Date 03/19/2020  
By [Signature]  
Miami-Dade Product Control

Approved as complying with the Florida Building Code  
Date 03/19/2015  
NOA# 14-1222-04  
Miami-Dade Product Control  
By [Signature]

SCOTT WALTERS  
FL PER# 62354  
SEAL: [Signature]  
WOLTERS ENGINEERING  
(COA# 27194)  
15211 97TH ROAD N  
WEST PALM BEACH, FL 33412  
PH/FAX: (561) 225-1982  
DEC 18 2014

**PANEL MATERIAL/FINISHES**  
SCALE: NOT TO SCALE

**HUNTER DOUGLAS ARCHITECTURAL PRODUCTS**

5015 Oakbrook Parkway, Suite 100  
Norcross, GA 30093  
800-366-4327 / 770-806-9557  
Fax: 770-806-0214

www.hunterdouglascontract.com

SPECIFICATIONS (unless noted otherwise)	
MATERIAL:	150F PANEL: .025" ALUMINUM ALLOY 3005-H48 150F CARRIER: 0.040" ALUMINUM ALLOY 5050-H48
FINISHES:	PAINT / POWDER COAT / DECORATED WOOD FINISH / LUXACOTE
PERFORATION:	#124 (15% OPEN)

TOLERANCES (unless noted otherwise)	
DECIMAL:	.0 +/- .060 .00 +/- .030 .000 +/- .010
FRACTIONAL:	$\pm \frac{1}{32}$
ANGULAR:	$\pm \frac{1}{2}$ (.5°)

**PANEL SPEC**

PROJECT: 150F PRODUCT SPECIFICATIONS  
DRAWING NUMBER: 150F-B1.1  
PART NUMBER: N/A  
SCALE: 3" = 1'-0"  
DATE: 11/11/14  
DRAWN BY: HDAP ENGINEERING

**PRODUCT REVISED**  
 as complying with the Florida  
 Building Code  
 NOA-No. **17-0807.10**  
 Expiration Date **03/19/2020**  
 By *[Signature]*  
 Miami-Dade Product Control

**NOTE A:**

CARRIER SPACING (PANEL SPAN) AND CARRIER SPAN (HANGER WIRE & VERTICAL SUPPORT SPACING) VARIES DEPENDING ON DESIGN WIND PRESSURE (POUNDS PER SQUARE FOOT). AS A GENERAL GUIDE, REFER TO THE DETAIL AND WIND LOAD TABLE 1 BELOW FOR CARRIER SPACING AND CARRIER SPAN. THE WIND LOAD CRITERIA IS BASED ON USING 3 OR MORE ROWS OF CARRIER. MAXIMUM PANEL OVERHANG = 6". MAXIMUM CARRIER OVERHANG = 6".

HANGER WIRE (12 GA MIN.) MUST BE LOCATED AT EACH VERTICAL SUPPORT STRUT. VERTICAL SUPPORT STRUT MUST NOT EXCEED SPACING SHOWN FOR A GIVEN DESIGN WIND PRESSURE. SEE DRAWING # 150F-B1.3 FOR VERTICAL SUPPORT SPECIFICATION. HANGER WIRE AND VERTICAL SUPPORT STRUT MUST BE ATTACHED TO STRUCTURE ABOVE TO SAFELY SUPPORT ALL LOADS IMPOSED BY SOFFIT SYSTEM.

**MATERIAL:** 150F CARRIER\*  
 .040" ALUMINUM ALLOY 5050-H48  
**FINISH:** MATTE BLACK  
**PART LENGTH:** 16'-0"

\*CONTAINS INTEGRAL SPLICE

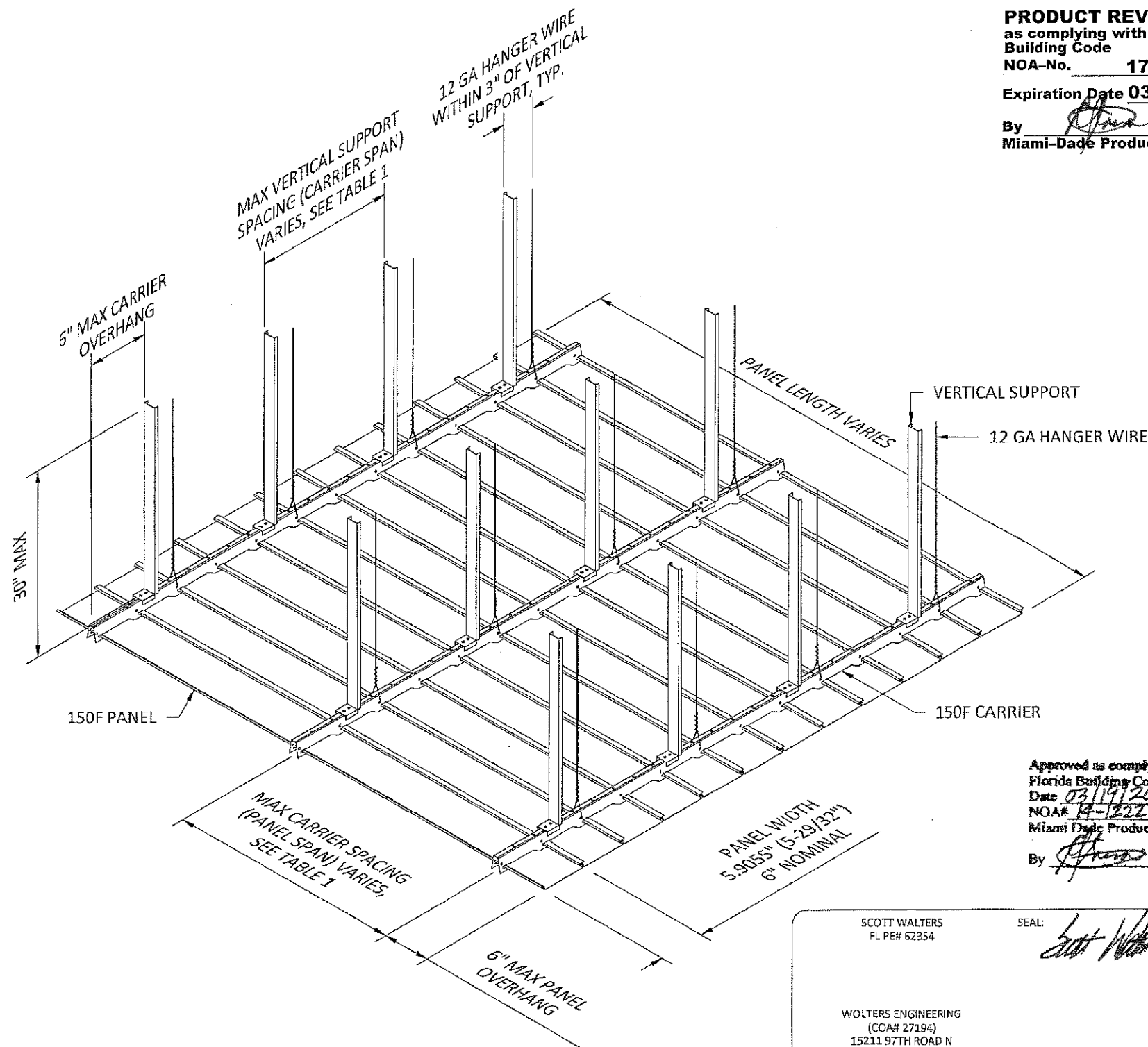

Approved as complying with the  
 Florida Building Code  
 Date **03/19/2015**  
 NOA# **14-1222-04**  
 Miami Dade Product Control  
 By *[Signature]*

SCOTT WALTERS  
 FL PER# 62354

SEAL: *[Signature]*

WALTERS ENGINEERING  
 (COA# 27194)  
 15211 97TH ROAD N  
 WEST PALM BEACH, FL 33412  
 PH/FAX: (561) 225-1982

DEC 18 2014

**TABLE 1 - DESIGN WIND LOAD - 150F EXTERIOR CEILING SYSTEM**

PANEL MATERIAL: .025" ALUMINUM  
 CARRIER MATERIAL: .040" ALUMINUM

ALLOWABLE CARRIER SPACING (PANEL SPAN)  
 ALLOWABLE CARRIER SUPPORT SPACING (HANGER WIRE/VERTICAL SUPPORT SPACING)

* CARRIER SPACING BASED ON USING 3 OR MORE CARRIERS		
** POUNDS PER SQUARE FOOT		
DESIGN WIND PRESSURE (POSITIVE OR NEGATIVE PSF**)	CARRIER SPACING * (PANEL SPAN)	CARRIER SPAN (VERTICAL SUPPORT SPACING)
20	49"	20"
25	40"	20"
30	34"	20"
35	29"	20"
40	26"	20"
50	22"	20"
55	21"	20"
60	18"	20"
75	16"	20"

**EXTERIOR INSTALLATION**

**HUNTER DOUGLAS ARCHITECTURAL PRODUCTS**

5015 Oakbrook Parkway, Suite 100  
 Norcross, GA 30093  
 800-366-4327 / 770-806-9557  
 Fax: 770-806-0214

www.hunterdouglascontract.com

**SPECIFICATIONS**  
 (unless noted otherwise)

MATERIAL: 150F PANEL: .025" ALUMINUM ALLOY 3005-H48  
 150F CARRIER: 0.040" ALUMINUM ALLOY 5050-H48  
 FINISHES: PAINT / POWDER COAT / DECORATED WOOD FINISH / LUXACOTE  
 PERFORATION: #124 (15% OPEN)

**TOLERANCES**  
 (unless noted otherwise)

DECIMAL: .0 +/- .060  
 .00 +/- .030  
 .000 +/- .010  
 FRACTIONAL: +/- 1/32"  
 ANGULAR: +/- 1/2° (.5°)

**SUSPENSION SPEC**

PROJECT: 150F PRODUCT SPECIFICATIONS  
 DRAWING NUMBER: 150F-B1.2  
 PART NUMBER: N/A  
 SCALE: 3" = 1'-0"  
 DATE: 11/11/14  
 DRAWN BY: HDAP ENGINEERING

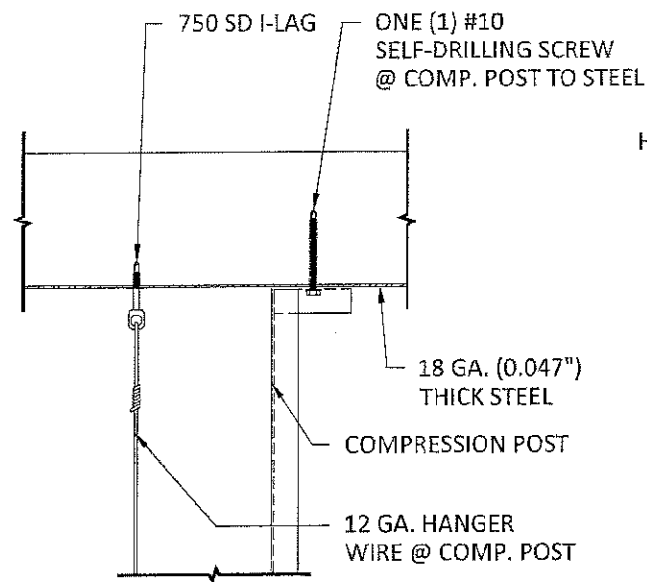

STEEL CONNECTION W/ I-LAGS & SELF-DRILLING SCREWS

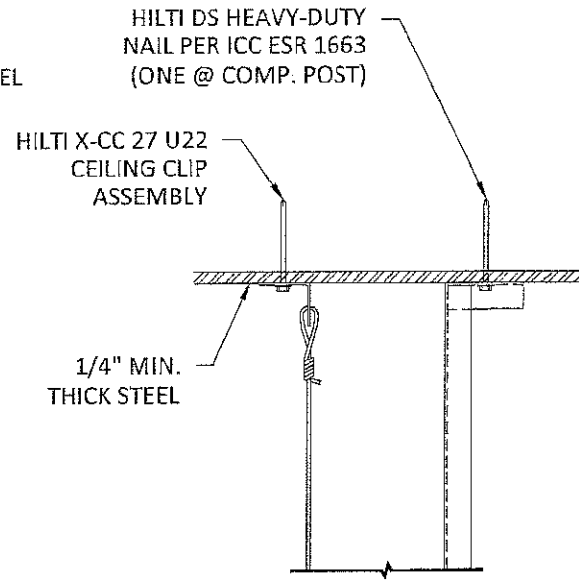

STEEL CONNECTION W/ SHOT PINS

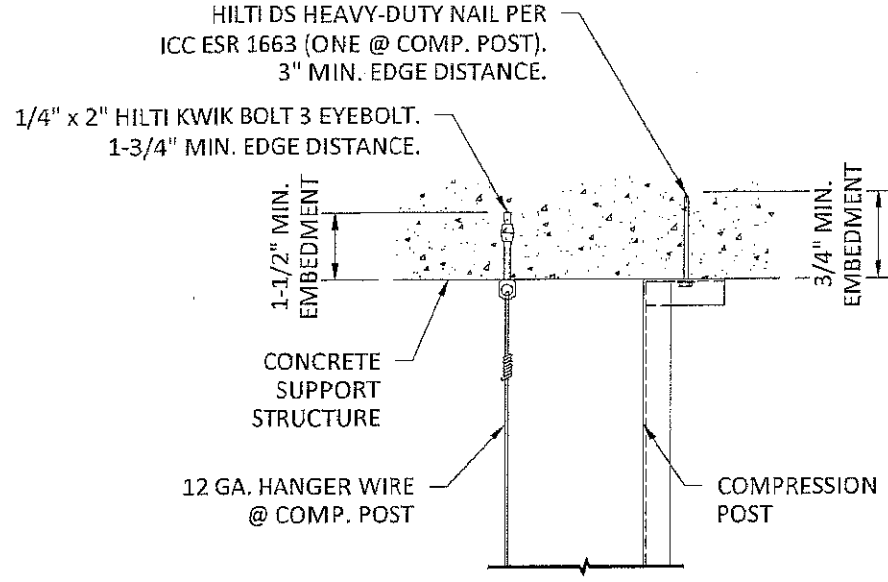

CONCRETE CONNECTION W/ EXP. ANCHORS & SHOT PINS

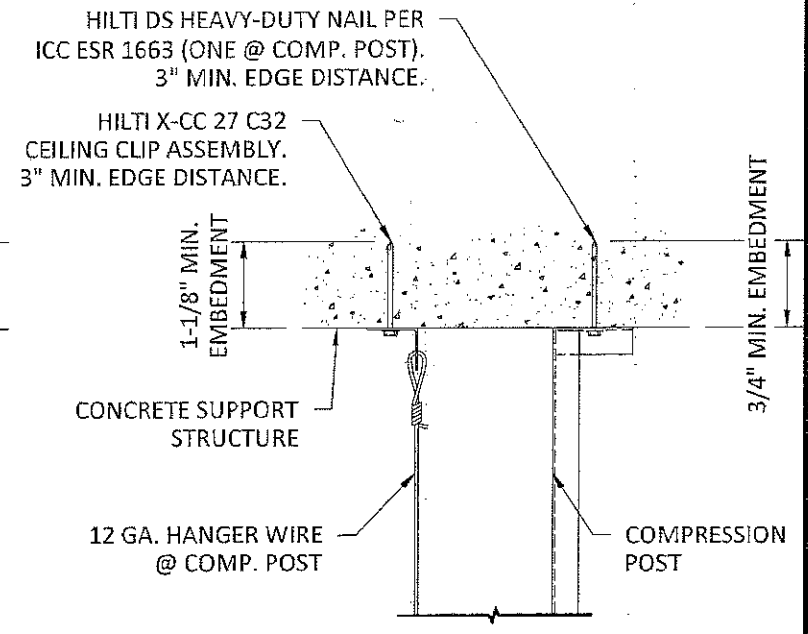

CONCRETE CONNECTION W/ SHOT PINS

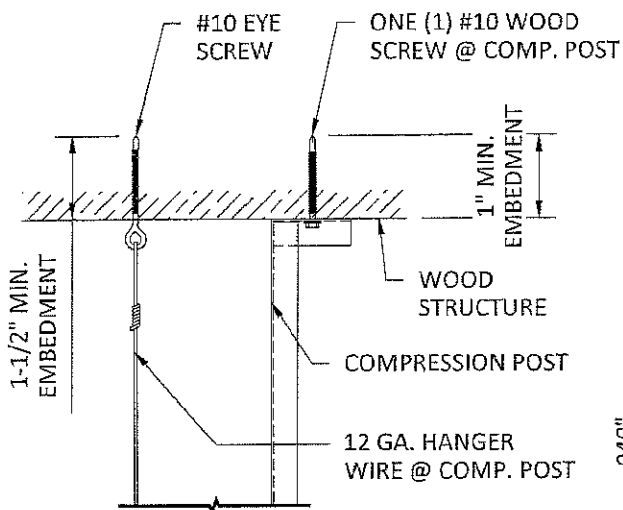

WOOD CONNECTION W/ WOOD SCREWS

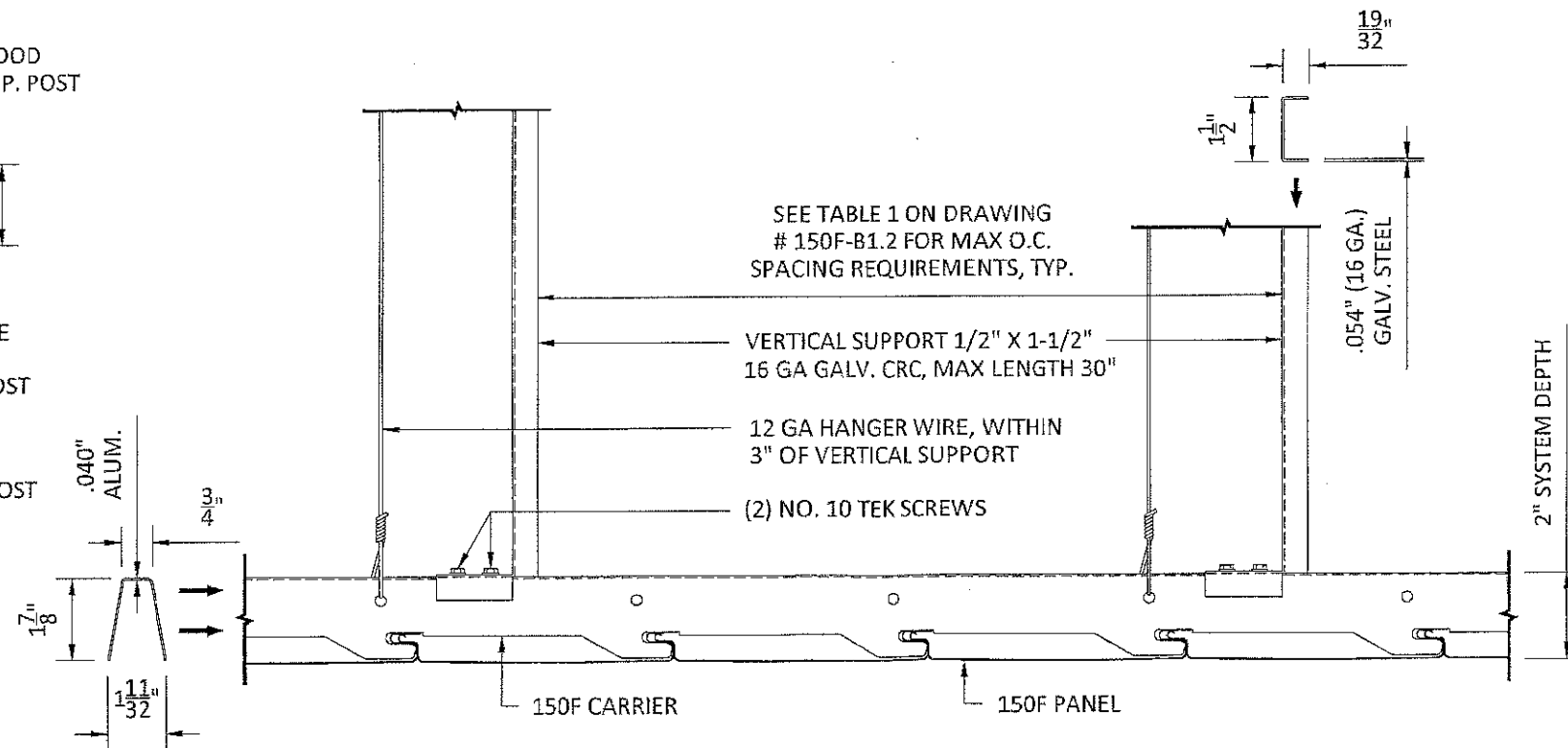

**A** SECTION AT VERTICAL SUPPORT ATTACHMENT  
SCALE: 3" = 1'-0"

**PRODUCT REVISED**  
as complying with the Florida Building Code  
NOA-No. **17-0807.10**  
Expiration Date **03/19/2020**  
By *[Signature]*  
Miami-Dade Product Control

Approved as complying with the Florida Building Code  
Date **03/19/2015**  
NOA# **14-1222-04**  
Miami-Dade Product Control  
By *[Signature]*

SCOTT WALTERS  
FL PE# 62354  
SEAL: *[Signature]*  
WOLTERS ENGINEERING  
(COA# 27194)  
1521.1 97TH ROAD N  
WEST PALM BEACH, FL 33412  
PH/FAX: (561) 225-1982  
DEC 18 2014

**EXTERIOR INSTALLATION**

**HUNTER DOUGLAS ARCHITECTURAL PRODUCTS**

5015 Oakbrook Parkway, Suite 100  
Norcross, GA 30093  
800-366-4327 / 770-806-9557  
Fax: 770-806-0214

www.hunterdouglascontract.com

**SPECIFICATIONS**  
(unless noted otherwise)  
MATERIAL: 150F PANEL: .025" ALUMINUM ALLOY 3005-H48  
150F CARRIER: 0.040" ALUMINUM ALLOY 5050-H48  
FINISHES: PAINT / POWDER COAT / DECORATED WOOD FINISH / LUXACOTE  
PERFORATION: #124 (15% OPEN)

**TOLERANCES**  
(unless noted otherwise)  
DECIMAL: .0 +/- .050  
.00 +/- .030  
.000 +/- .010  
FRACTIONAL: +/- 1/32"  
ANGULAR: +/- 1/2° (.5°)

**VERTICAL SUPPORT SPEC**

PROJECT: 150F PRODUCT SPECIFICATIONS  
DRAWING NUMBER: 150F-B1.3  
PART NUMBER: N/A  
SCALE: 3" = 1'-0"  
DATE: 11/11/14  
DRAWN BY: HDAP ENGINEERING

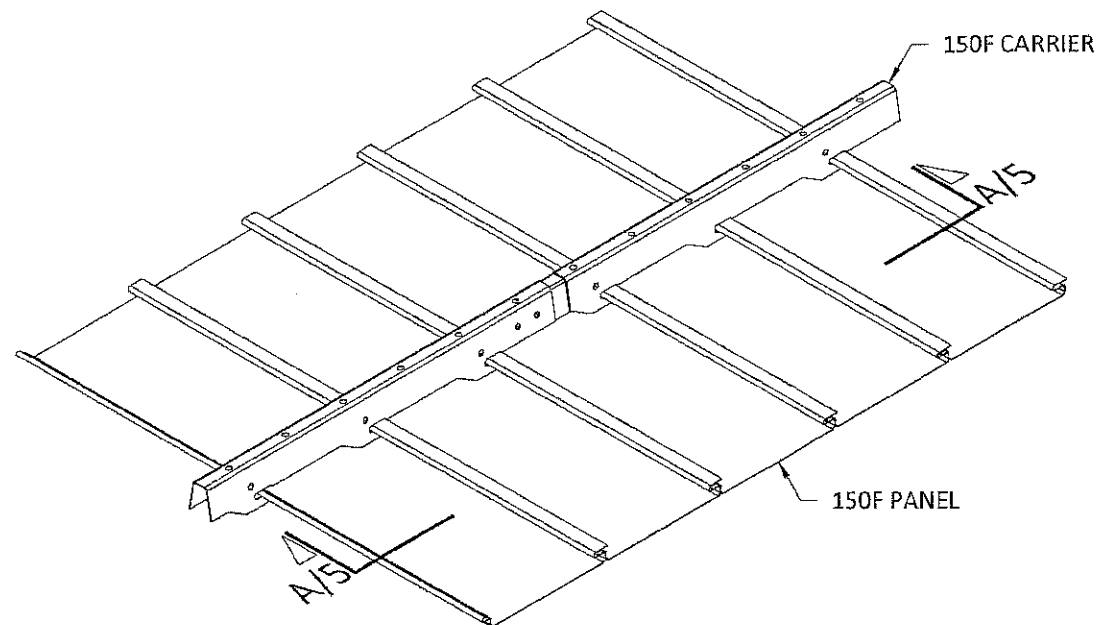

THE 150F CARRIER CONTAINS AN INTEGRAL SPLICE. NEST ONE END OF THE CARRIER INTO THE OTHER END AND LINE UP THE HOLES AND FLANGES TO MAINTAIN THE MODULE.

INSTALL #10 SCREW FASTENERS (2) ON EACH SIDE OF THE NESTED CARRIER ASSEMBLY, (4) TOTAL ARE REQUIRED TO SECURE THE CARRIERS.

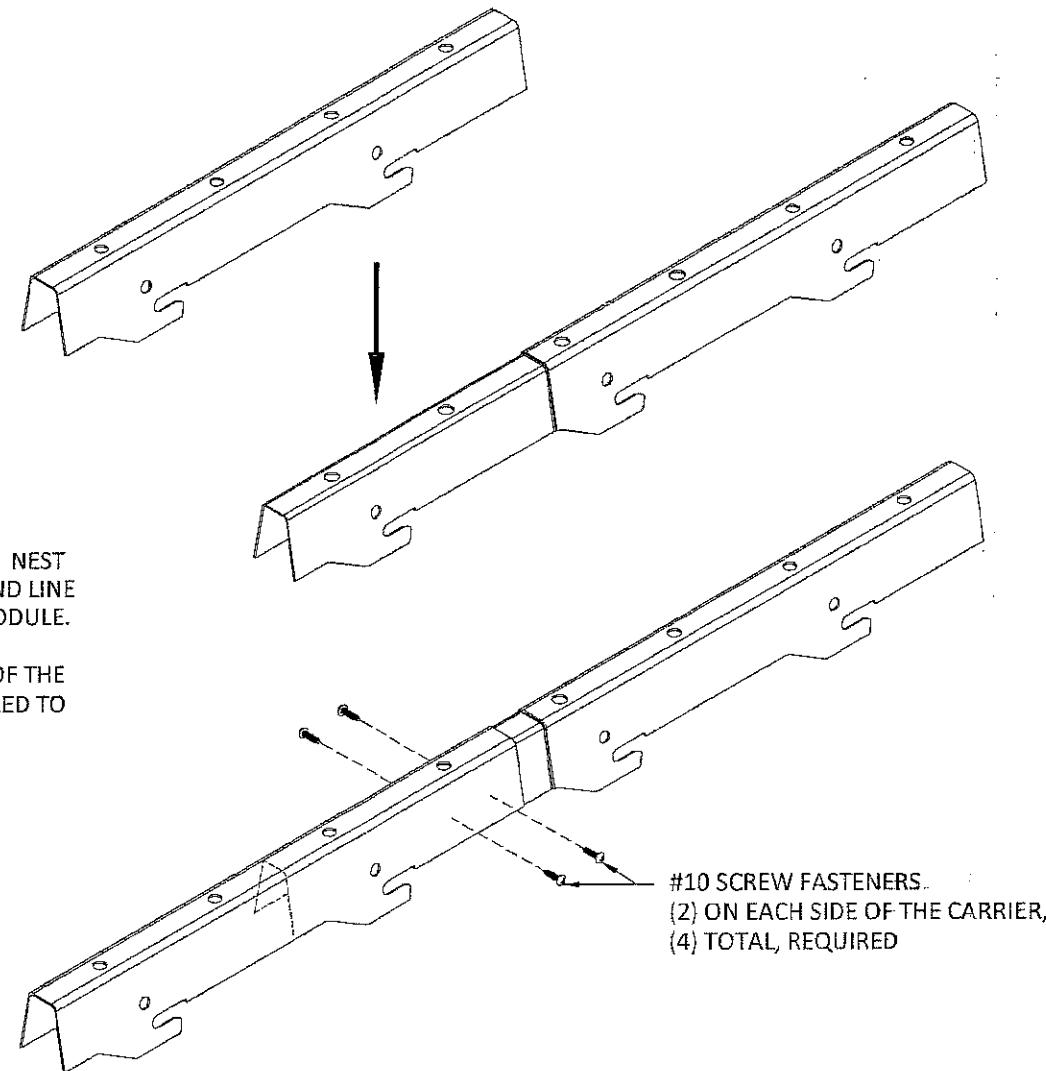

#10 SCREW FASTENERS (2) ON EACH SIDE OF THE CARRIER, (4) TOTAL, REQUIRED

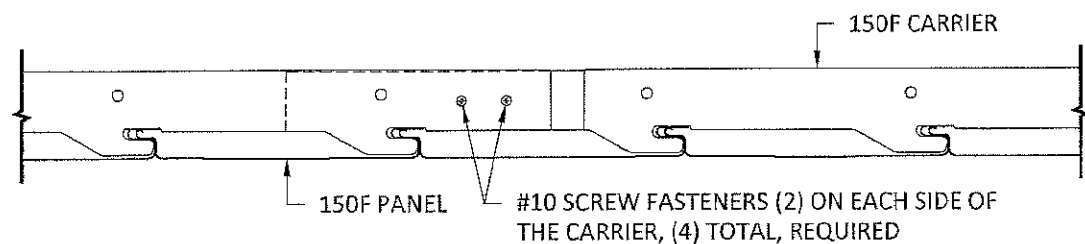

**A** SECTION AT INTEGRAL SPLICE  
**5** SCALE: 3" = 1'-0"

**PRODUCT REVISED**  
as complying with the Florida Building Code  
NOA-No. **17-0807.10**  
Expiration Date **03/19/2020**  
By *[Signature]*  
Miami-Dade Product Control

Approved as complying with the Florida Building Code  
Date **03/19/2015**  
NOA# **17-1222.04**  
Miami-Dade Product Control  
By *[Signature]*

SCOTT WALTERS  
FL PE# 62354  
SEAL: *[Signature]*

WOLTERS ENGINEERING  
(COA# 27194)  
15211 97TH ROAD N  
WEST PALM BEACH, FL 33412  
PH/FAX: (561) 225-1982

DEC 18 2014

\*VERTICAL SUPPORT OMITTED FOR CLARITY

**EXTERIOR INSTALLATION**

**HUNTER DOUGLAS ARCHITECTURAL PRODUCTS**

5015 Oakbrook Parkway, Suite 100  
Norcross, GA 30093  
800-366-4327 / 770-806-9557  
Fax: 770-806-0214

www.hunterdouglascontract.com

**SPECIFICATIONS**  
(unless noted otherwise)  
MATERIAL: 150F PANEL: .025" ALUMINUM ALLOY 3005-H48  
150F CARRIER: 0.040" ALUMINUM ALLOY 5050-H48  
FINISHES: PAINT / POWDER COAT / DECORATED WOOD FINISH / LUXACOTE  
PERFORATION: #124 (15% OPEN)

**TOLERANCES**  
(unless noted otherwise)  
DECIMAL: .0 +/- .060  
.00 +/- .030  
.000 +/- .010  
FRACTIONAL: +/- 1/32"  
ANGULAR: +/- 1/2° (1.5°)

**CARRIER SPLICE**

PROJECT: 150F PRODUCT SPECIFICATIONS  
DRAWING NUMBER: 150F-B1.4  
PART NUMBER: N/A  
SCALE: 3" = 1'-0"  
DATE: 11/11/14  
DRAWN BY: HDAP ENGINEERING



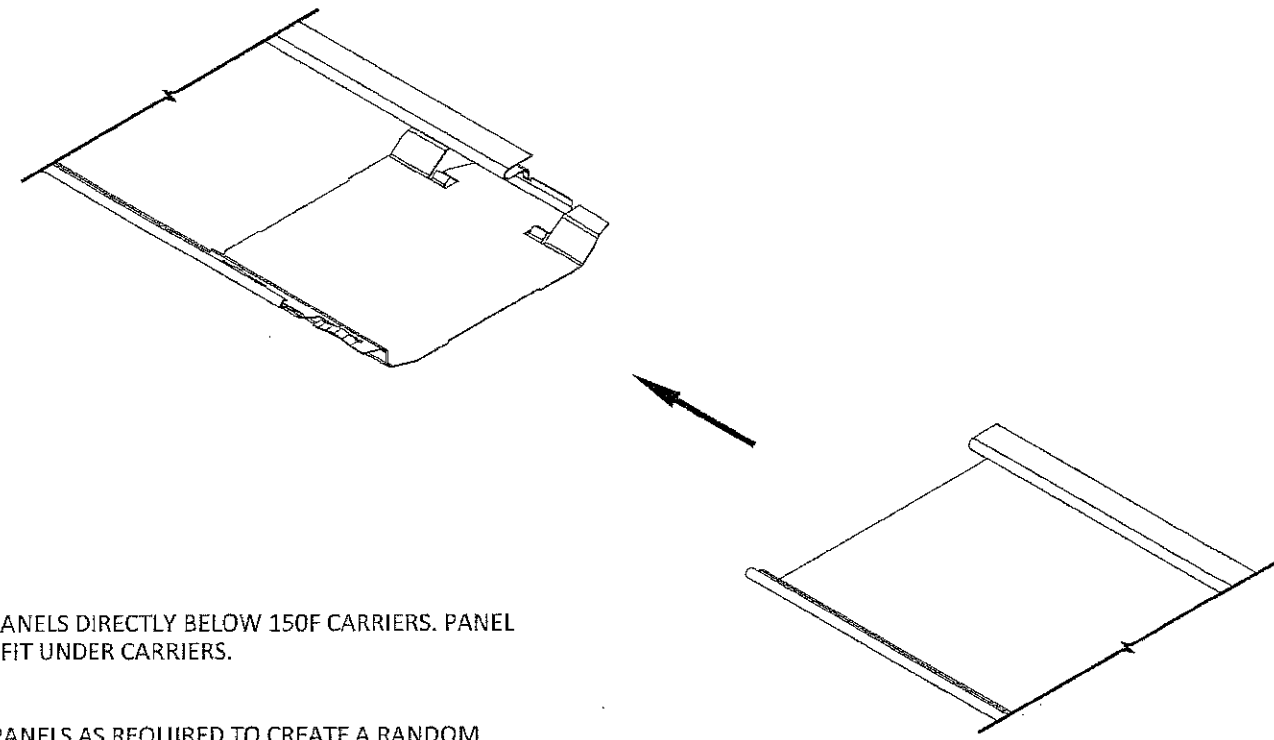
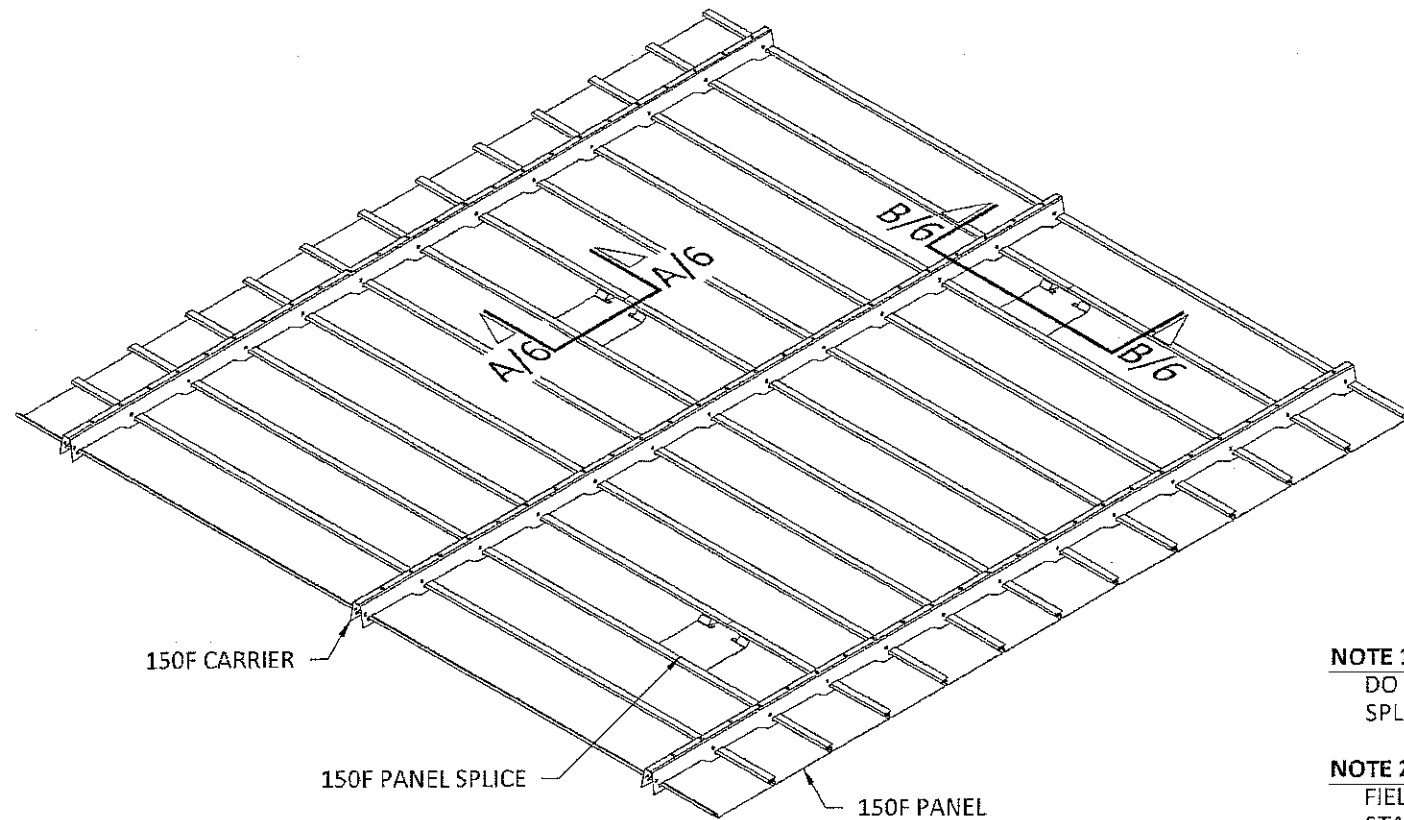

**NOTE 1:**  
DO NOT SPLICE PANELS DIRECTLY BELOW 150F CARRIERS. PANEL SPLICES DO NOT FIT UNDER CARRIERS.

**NOTE 2:**  
FIELD CUT 150F PANELS AS REQUIRED TO CREATE A RANDOM STAGGERED SEAM PATTERN. AVOID ALIGNED SEAMS.

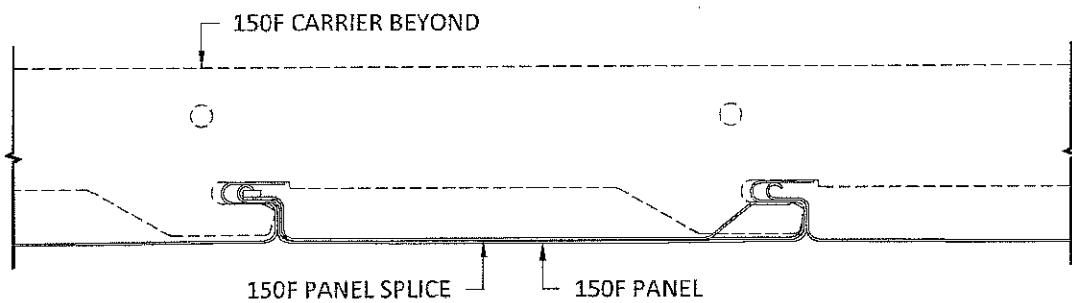

**A** SECTION AT PANEL SPLICE  
6 SCALE: 6" = 1'-0"

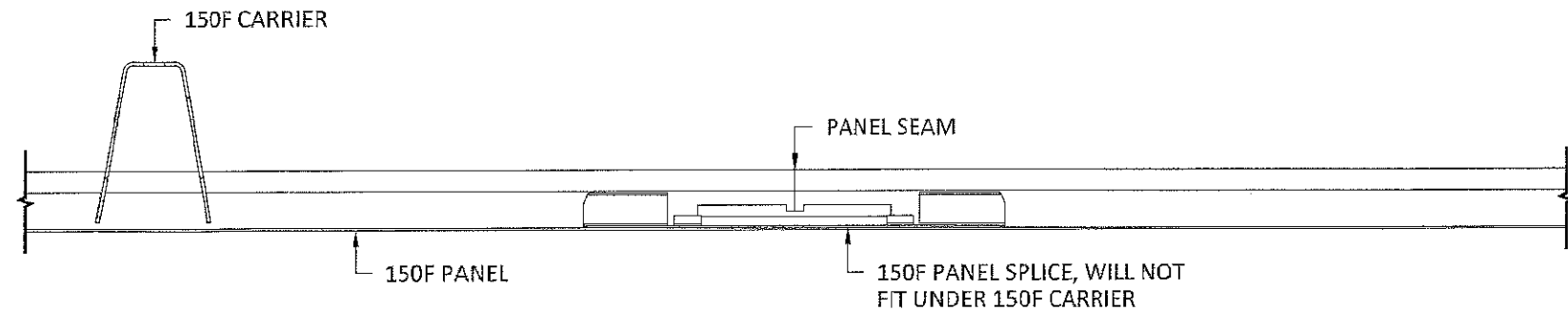

**B** SECTION AT PANEL SPLICE  
6 SCALE: 6" = 1'-0"

**PRODUCT REVISED**  
as complying with the Florida Building Code  
NOA-No. **17-0807.10**  
Expiration Date **03/19/2020**  
By *[Signature]*  
Miami-Dade Product Control

Approved as complying with the Florida Building Code  
Date **03/19/2015**  
NOA# **14-1227.04**  
Miami-Dade Product Control  
By *[Signature]*

SCOTT WALTERS  
FL PE# 62354  
SEAL: *[Signature]*

WOLTERS ENGINEERING  
(COA# 27194)  
15211 97TH ROAD N  
WEST PALM BEACH, FL 33412  
PH/FAX: (561) 225-1982

DEC 18 2014

**EXTERIOR INSTALLATION**

\*VERTICAL SUPPORT OMITTED FOR CLARITY

**HUNTER DOUGLAS ARCHITECTURAL PRODUCTS**

5015 Oakbrook Parkway, Suite 100  
Norcross, GA 30093  
800-366-4327 / 770-806-9557  
Fax: 770-806-0214

www.hunterdouglascontract.com

**SPECIFICATIONS**  
(unless noted otherwise)

MATERIAL: 150F PANEL: .025" ALUMINUM ALLOY 3005-H48  
150F CARRIER: 0.040" ALUMINUM ALLOY 5050-H48  
FINISHES: PAINT / POWDER COAT / DECORATED WOOD FINISH / LUXACOTE  
PERFORATION: #124 (15% OPEN)

**TOLERANCES**  
(unless noted otherwise)

DECIMAL: .0 +/- .060  
.00 +/- .030  
.000 +/- .010  
FRACTIONAL: +/- 1/32"  
ANGULAR: +/- 1/2° (15°)

**PANEL SPLICE SPEC**

PROJECT: 150F PRODUCT SPECIFICATIONS  
DRAWING NUMBER: 150F-B1.5  
PART NUMBER: N/A  
SCALE: 3" = 1'-0"  
DATE: 11/11/14  
DRAWN BY: HDAP ENGINEERING

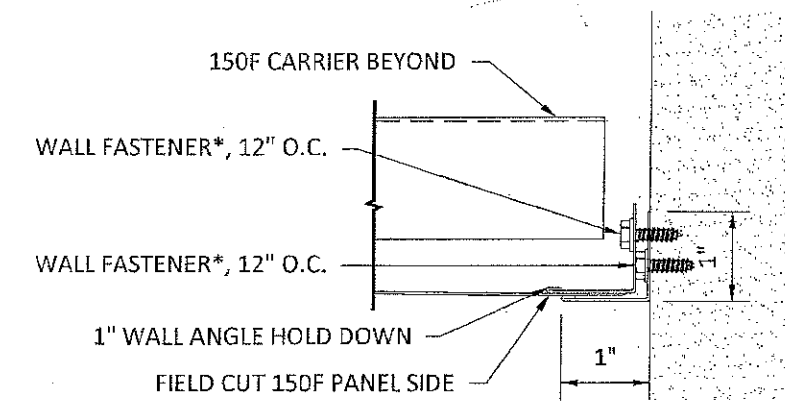
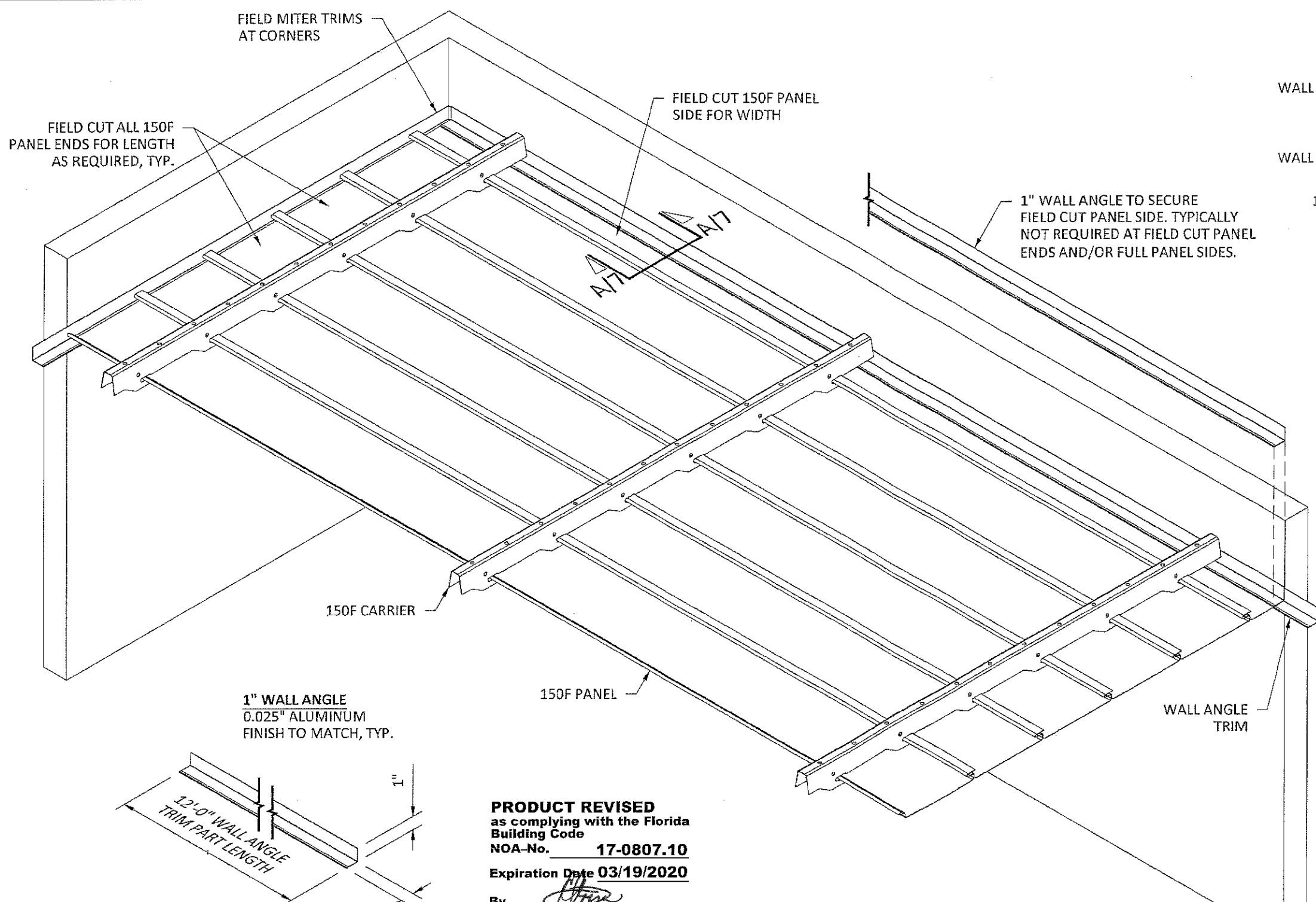

**A**  
**7** SECTION AT WALL ANGLE  
SCALE: 6" = 1'-0"

**WALL FASTENER TYPES\*:**

- WOOD - #10 WOOD SCREW W/  
1-1/2" MIN. EMBED AND  
3/4" MIN. EDGE DISTANCE
- CONCRETE - 3/16" DIA. TAPCON W/  
1-1/4" MIN. EMBED AND  
1-1/2" MIN. EDGE DISTANCE.
- STEEL/ALUM. - #10 TEK SCREW W/ FULL EMBED  
THRU 18 GA. (MIN.) STEEL OR  
1/8" (MIN.) ALUMINUM W/  
3/4" MIN. EDGE DISTANCE.

Approved as complying with the  
Florida Building Code  
Date 03/19/2015  
NOA# 14-1227.04  
Miami-Dade Product Control  
By [Signature]

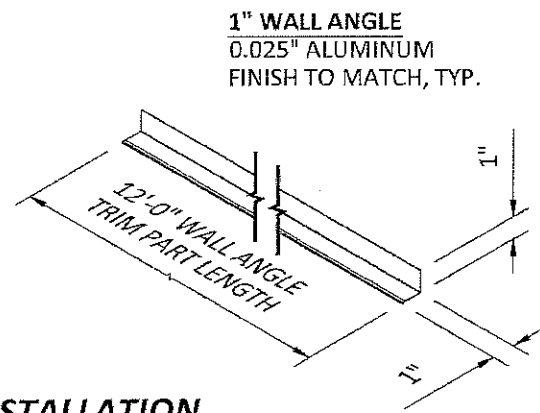

**PRODUCT REVISED**  
as complying with the Florida  
Building Code  
NOA-No. **17-0807.10**  
Expiration Date **03/19/2020**  
By [Signature]  
Miami-Dade Product Control

SCOTT WALTERS  
FL PE# 62354

SEAL: [Signature]

WALTERS ENGINEERING  
(COA# 27194)  
15211 97TH ROAD N  
WEST PALM BEACH, FL 33412  
PH/FAX: (561) 225-1982

DEC 18 2014

**EXTERIOR INSTALLATION**

\*VERTICAL SUPPORT OMITTED FOR CLARITY

<b>HUNTER DOUGLAS ARCHITECTURAL PRODUCTS</b>  5015 Oakbrook Parkway, Suite 100 Norcross, GA 30093 800-366-4327 / 770-806-9557 Fax: 770-806-0214	www.hunterdouglascontract.com	<b>SPECIFICATIONS</b> (unless noted otherwise) MATERIAL: 150F PANEL: .025" ALUMINUM ALLOY 3005-H48 150F CARRIER: 0.040" ALUMINUM ALLOY 5050-H48 FINISHES: PAINT / POWDER COAT / DECORATED WOOD FINISH / LUXACOTE PERFORATION: #124 (15% OPEN)	<b>TOLERANCES</b> (unless noted otherwise) DECIMAL: .0 +/- .060 .00 +/- .030 .000 +/- .010 FRACTIONAL: +/- 1/16" ANGULAR: +/- 1/2° (5°)	<b>WALL ANGLE TRIM</b>  PROJECT: 150F PRODUCT SPECIFICATIONS DRAWING NUMBER: 150F-B1.6 PART NUMBER: N/A SCALE: 3" = 1'-0" DATE: 11/11/14 DRAWN BY: HDAP ENGINEERING
		HUNTER DOUGLAS ARCHITECTURAL PRODUCTS		

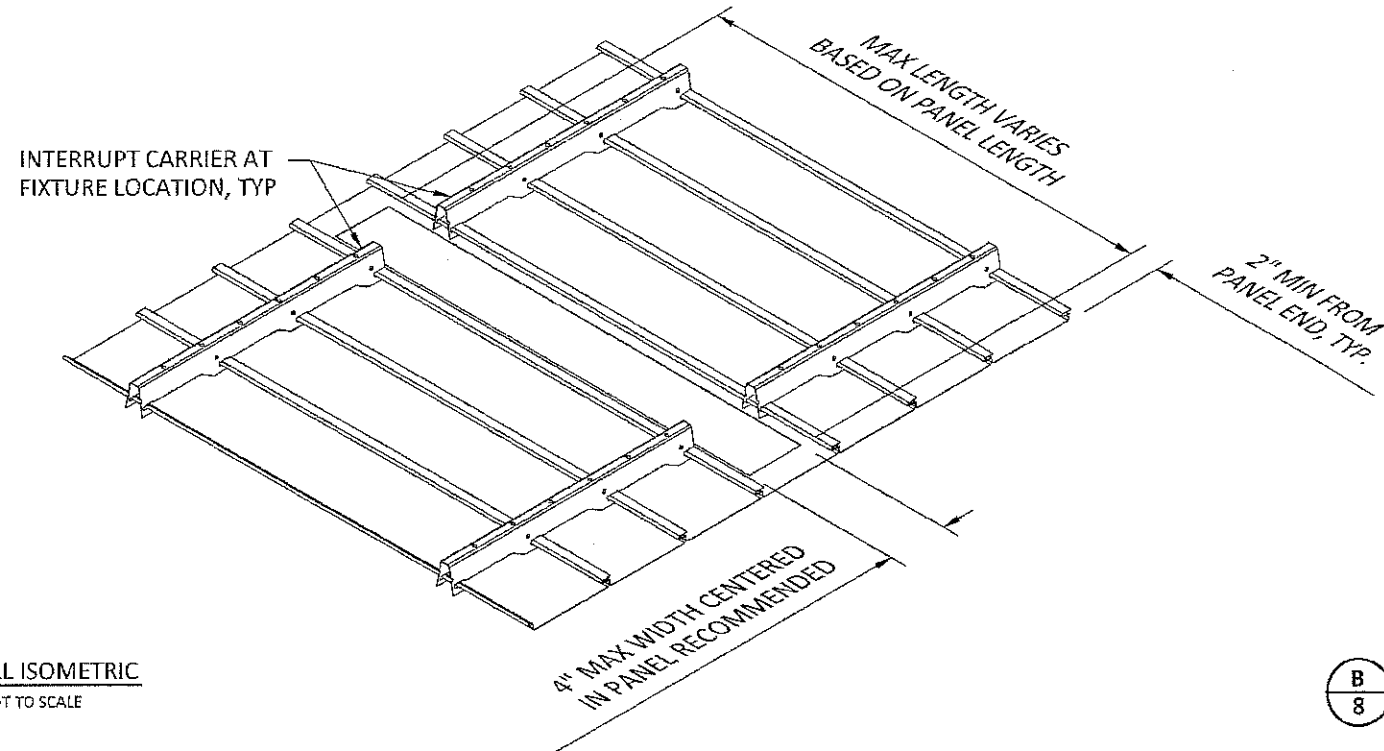

**A**  
**8** TYPICAL ISOMETRIC  
SCALE: NOT TO SCALE

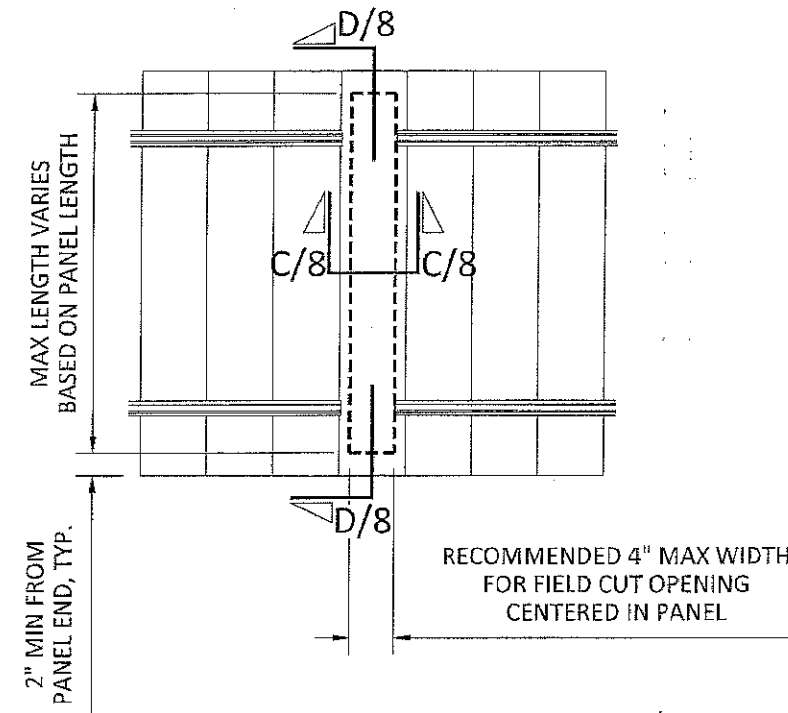

**B**  
**8** TYPICAL R.C.P.  
SCALE: NOT TO SCALE

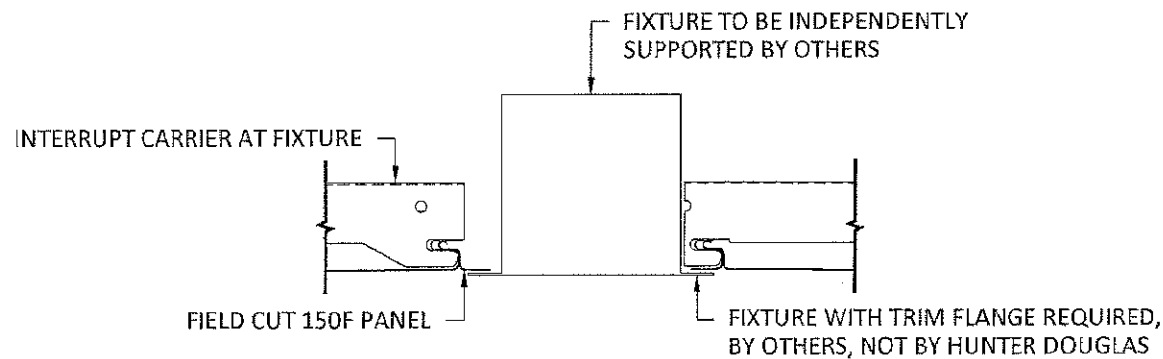

**C**  
**8** SECTION AT FIXTURE OPENING  
SCALE: 3" = 1'-0"

**PRODUCT REVISED**  
as complying with the Florida Building Code  
NOA-No. **17-0807.10**  
Expiration Date **03/19/2020**  
By *[Signature]*  
Miami-Dade Product Control

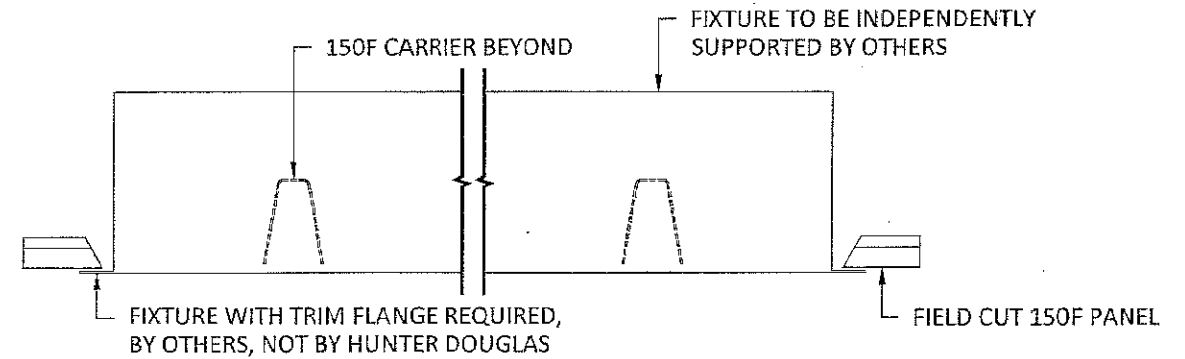

**D**  
**8** SECTION AT FIXTURE OPENING  
SCALE: 3" = 1'-0"

**NOTE: ROUND OPENINGS LESS THAN EIGHT (8) INCHES DIAMETER TYPICALLY FIELD CUT INTO PANEL FACE, TRIM FOR ALL FIXTURES BY OTHERS, NOT BY HUNTER DOUGLAS**

Approved as complying with the Florida Building Code  
Date **03/19/2015**  
NOA# **14-1222.04**  
Miami Dade Product Control  
By *[Signature]*

SCOTT WALTERS  
FL PE# 62354  
SEAL: *[Signature]*

WOLTERS ENGINEERING  
(COA# 27194)  
15211 97TH ROAD N  
WEST PALM BEACH, FL 33412  
PH/FAX: (561) 225-1982

DEC 18 2014

\*VERTICAL SUPPORT OMITTED FOR CLARITY

**HUNTER DOUGLAS ARCHITECTURAL PRODUCTS**

5015 Oakbrook Parkway, Suite 100  
Norcross, GA 30093  
800-366-4327 / 770-806-9557  
Fax: 770-806-0214

www.hunterdouglascontract.com

**SPECIFICATIONS**  
(unless noted otherwise)

MATERIAL: 150F PANEL: .025" ALUMINUM ALLOY 3005-H48  
150F CARRIER: 0.040" ALUMINUM ALLOY 5050-H48  
FINISHES: PAINT / POWDER COAT / DECORATED WOOD FINISH / LUXACOTE  
PERFORATION: #124 (15% OPEN)

**TOLERANCES**  
(unless noted otherwise)

DECIMAL: .0 +/- .060  
.00 +/- .030  
.000 +/- .010  
FRACTIONAL: +/- 1/32"  
ANGULAR: +/- 1/2° (.5°)

**FIELD CUT PANEL FOR FIXTURE OPENINGS**

PROJECT: 150F PRODUCT SPECIFICATIONS  
DRAWING NUMBER: 150F-B1.8  
PART NUMBER: N/A  
SCALE: 3" = 1'-0"  
DATE: 11/11/14  
DRAWN BY: HDAP ENGINEERING

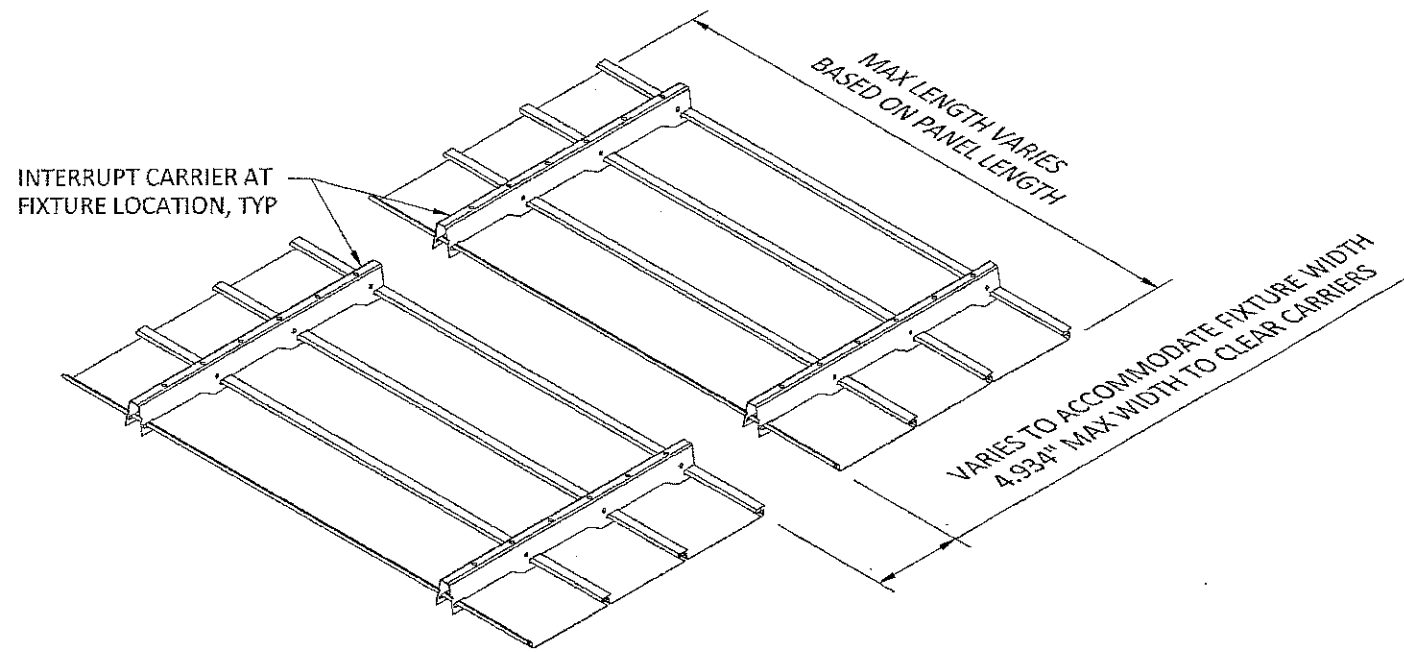

**A** TYPICAL ISOMETRIC  
9 SCALE: NOT TO SCALE

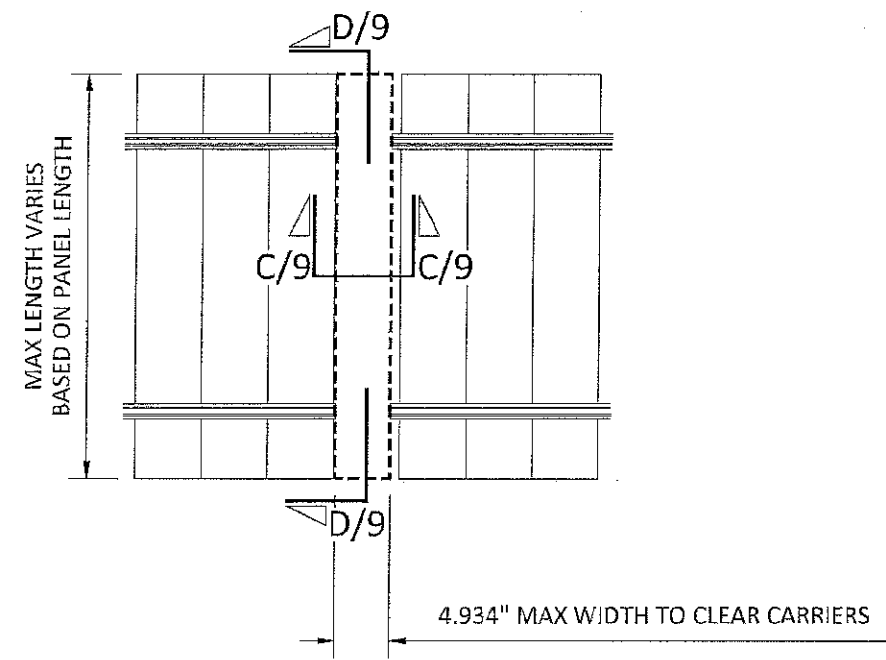

**B** TYPICAL R.C.P.  
9 SCALE: NOT TO SCALE

**PRODUCT REVISED**  
as complying with the Florida Building Code  
NOA-No. **17-0807.10**  
Expiration Date **03/19/2020**  
By *[Signature]*  
Miami-Dade Product Control

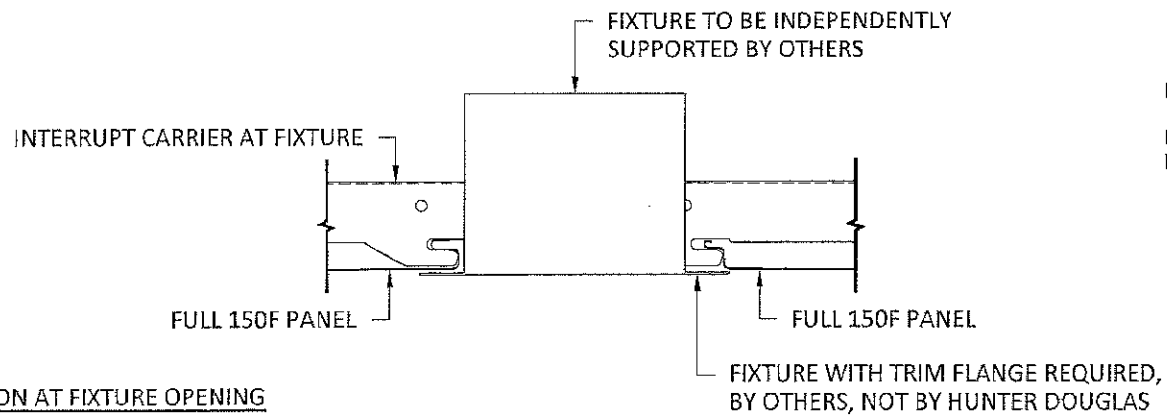

**C** SECTION AT FIXTURE OPENING  
9 SCALE: 3" = 1'-0"

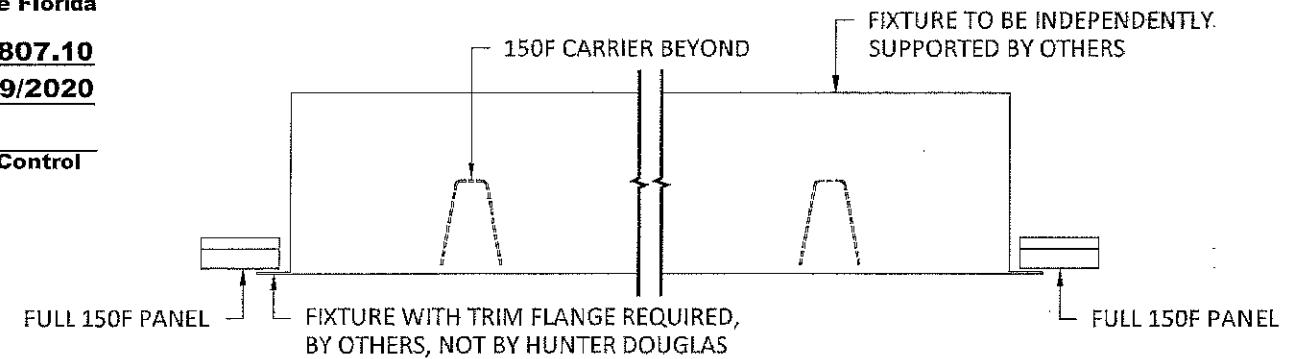

**D** SECTION AT FIXTURE OPENING  
9 SCALE: 3" = 1'-0"

**NOTE: FIXTURE WITH TRIM FLANGE NOT BY HUNTER DOUGLAS**

Approved as complying with the Florida Building Code.  
Date **03/19/2015**  
NOA# **14-1222.04**  
Miami-Dade Product Control  
By *[Signature]*

SCOTT WALTERS  
FL PE# 62354  
SEAL: *[Signature]*

WOLTERS ENGINEERING  
(COA# 27194)  
15211 97TH ROAD N  
WEST PALM BEACH, FL 33412  
PH/FAX: (561) 225-1982

DEC 18 2014

\*VERTICAL SUPPORT OMITTED FOR CLARITY

**HUNTER DOUGLAS ARCHITECTURAL PRODUCTS**

5015 Oakbrook Parkway, Suite 100  
Norcross, GA 30093  
800-366-4327 / 770-806-9557  
Fax: 770-806-0214

www.hunterdouglascontract.com

**SPECIFICATIONS**  
(unless noted otherwise)  
MATERIAL: 150F PANEL: .025" ALUMINUM ALLOY 3005-H48  
150F CARRIER: 0.040" ALUMINUM ALLOY 5050-H48  
FINISHES: PAINT / POWDER COAT / DECORATED WOOD FINISH / LUXACOTE  
PERFORATION: #124 (15% OPEN)

**TOLERANCES**  
(unless noted otherwise)  
DECIMAL: .0 +/- .060  
.00 +/- .030  
.000 +/- .010  
FRACTIONAL: +/- 1/32"  
ANGULAR: +/- 1/2° (5")

**INTERRUPTED PANEL FOR FIXTURE OPENINGS**

PROJECT: 150F PRODUCT SPECIFICATIONS  
DRAWING NUMBER: 150F-B1.9  
PART NUMBER: N/A  
SCALE: 3" = 1'-0"  
DATE: 11/11/14  
DRAWN BY: HDAP ENGINEERING

SHEET 9 OF 10

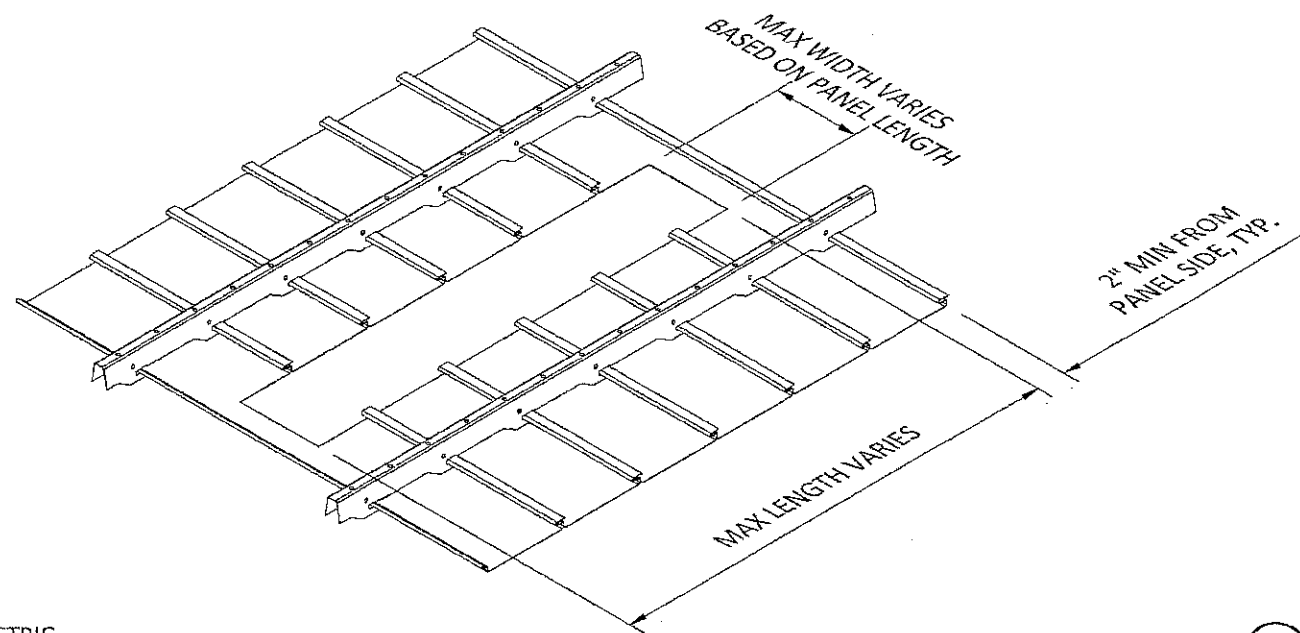

**A** TYPICAL ISOMETRIC  
10 SCALE: NOT TO SCALE

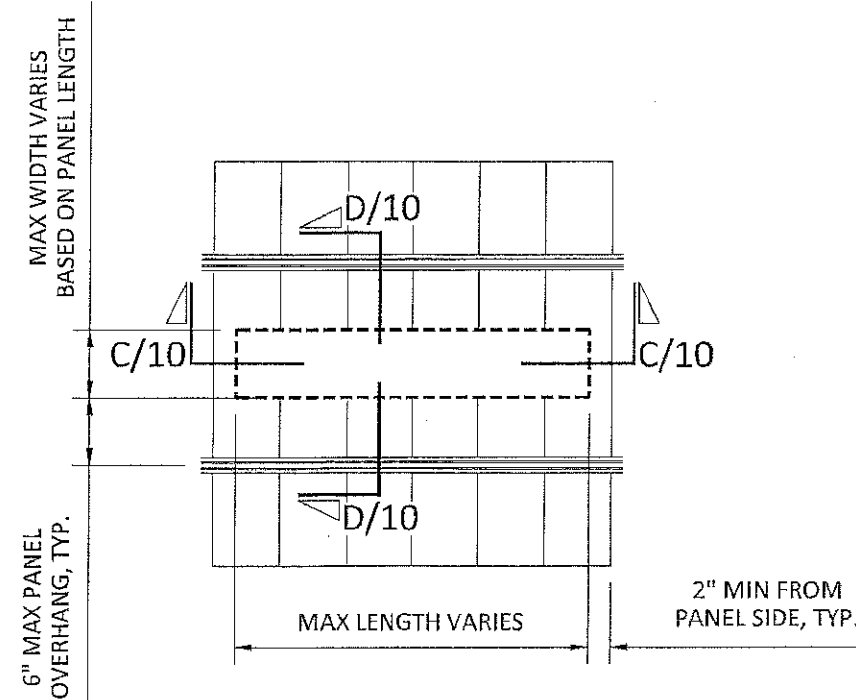

**B** TYPICAL R.C.P.  
10 SCALE: NOT TO SCALE

**PRODUCT REVISED**  
as complying with the Florida Building Code  
NOA-No. **17-0807.10**  
Expiration Date **03/19/2020**  
By *[Signature]*  
Miami-Dade Product Control

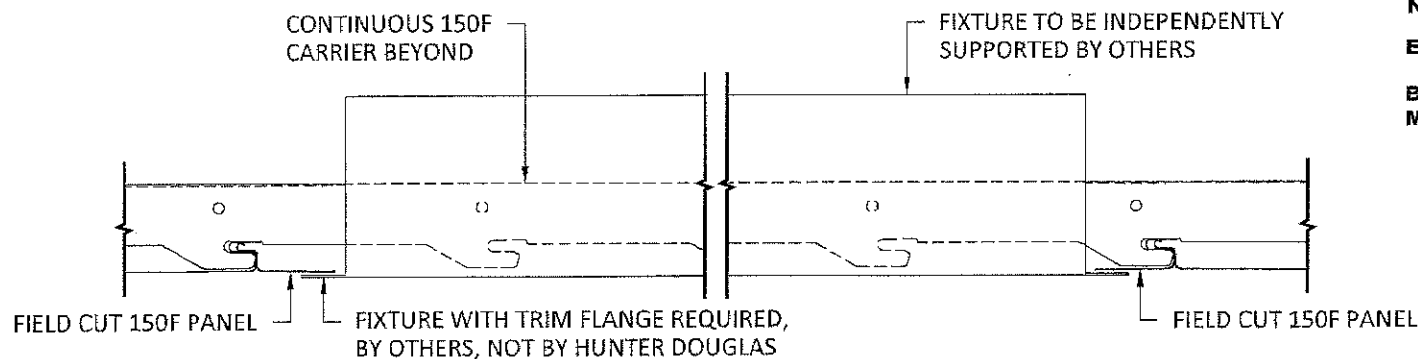

**C** SECTION AT FIXTURE OPENING  
10 SCALE: 3" = 1'-0"

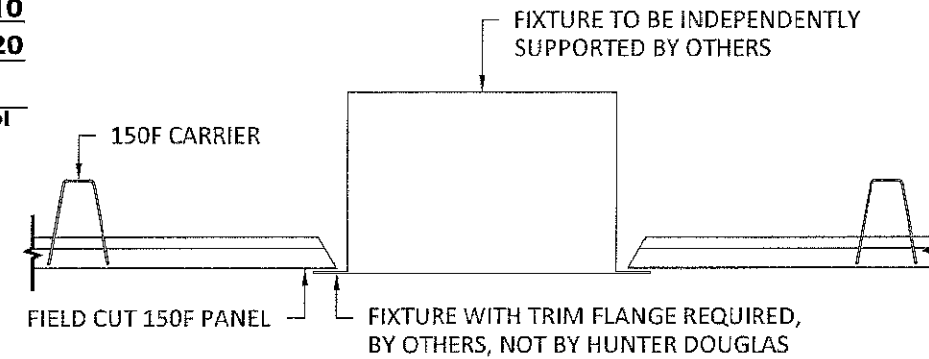

**D** SECTION AT FIXTURE OPENING  
10 SCALE: 3" = 1'-0"

**NOTE: ROUND OPENINGS LESS THAN EIGHT (8) INCHES DIAMETER TYPICALLY FIELD CUT INTO PANEL FACE, TRIM FOR ALL FIXTURES BY OTHERS, NOT BY HUNTER DOUGLAS**

Approved as complying with the Florida Building Code  
Date **03/19/2015**  
NOA# **14-1222-04**  
Miami-Dade Product Control  
By *[Signature]*

SCOTT WALTERS  
FL PE# 62354

SEAL: *[Signature]*

WALTERS ENGINEERING  
(COA# 27194)  
15211 97TH ROAD N  
WEST PALM BEACH, FL 33412  
PH/FAX: (561) 225-1982

DEC 18 2014

\*VERTICAL SUPPORT OMITTED FOR CLARITY

**HUNTER DOUGLAS ARCHITECTURAL PRODUCTS**

5015 Oakbrook Parkway, Suite 100  
Norcross, GA 30093  
800-366-4327 / 770-806-9557  
Fax: 770-806-0214

www.hunterdouglascontract.com

**SPECIFICATIONS**  
(unless noted otherwise)

MATERIAL: 150F PANEL: .025" ALUMINUM ALLOY 3005-H48  
150F CARRIER: 0.040" ALUMINUM ALLOY 5050-H48  
FINISHES: PAINT / POWDER COAT / DECORATED WOOD FINISH / LUXACOTE  
PERFORATION: #124 (15% OPEN)

**TOLERANCES**  
(unless noted otherwise)

DECIMAL: .0 +/- .060  
.00 +/- .030  
.000 +/- .010  
FRACTIONAL: +/- 1/32"  
ANGULAR: +/- 1/2° (.5°)

**FIELD CUT PANEL FOR FIXTURE OPENINGS**

PROJECT: 150F PRODUCT SPECIFICATIONS  
DRAWING NUMBER: 150F-B1.10  
PART NUMBER: N/A  
SCALE: 3" = 1'-0"  
DATE: 11/11/14  
DRAWN BY: HDAP ENGINEERING