

# ULTRAFLEX™



**ULTRAFLEX™ 325** has a smaller flange width and is designed for shorter runs (spans < 10 feet).

- **WORLD'S #1 FLEX PRODUCT FOR ALL OFF-ANGLES**
- **ULTRA-THIN EDGE FOR 1-STEP IN STALLATION AND EASY FINISHING**
- **ABSOLUTELY WILL NOT CRACK**



**ULTRAFLEX™ 450** with its wider width is designed for longer runs (spans > 10 feet).



**ZOOMA-FLEX®** is the only flex product that runs through an automatic taping tool.

## INSTALLATION:



Using a 4" – 6" tapping knife, apply All-Purpose compound to drywall slightly beyond where the edge of the corner will be. Place **NO-COAT® ULTRAFLEX™** or **ZOOMA-FLEX®** corner on wall and press into position. Embed trim by running knife over it with even pressure and squeeze out excess mud. Using the same knife, skim over the corner with the compound. Let dry.

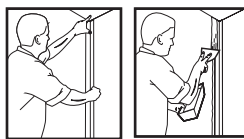

Using a 6" – 8" finishing knife, skim over the **ULTRAFLEX™** or **ZOOMA-FLEX®** once more. Let dry. Sand and paint.

## THE NO-COAT STRUCTURAL LAMINATE DRYWALL CORNER SYSTEM:

The NO-COAT Structural Laminate (SLAM) corner design represents a revolutionary drywall corner system that provides superior strength and durability, installs faster, and delivers bottom line savings in labor and materials. Whether finishing off-angles, inside or outside corners, NO-COAT offers a complete corner system for every job.

### STRONGEST

- Won't crack, dent, chip, peel or rust
- Long-lasting, virtually indestructible
- Stands up to severe impacts
- Permanently bonds corner to drywall with All-Purpose joint compound

### MOST DURABLE

- Absorbs settling and seismic movements
- Joint paper resists abrasion
- Surface paper will not "alligator" or wrinkle

### MOST FLEXIBLE

- Built-in flexible hinge adjusts to any inside or outside corner.

### FORMS PRECISE, STRAIGHT CORNERS

- Adjusts to correct irregular framing
- Tapered co-polymer core ensures perfectly straight corners – every time.
- Uniformly accepts paint and texture for a superior finish

### SAVES LABOR AND MUD

- Eliminates up to 50% of joint compound
- Reduces installation time by 30-50%



Made With **SLAM TECHNOLOGY**

1.888.662.6281

www.no-coat.com

ULTRATRIM™

### OUTSIDE 90°



**OUTSIDE 90°** also opens to a 135° corner or adjusts to any outside angle.



ULTRATRIM™

### INSIDE 90°



**INSIDE 90°** also opens to a 135° corner or adjusts to any inside angle.



#### INSTALLATION:



Using a 4" – 6" tapping knife, apply All-Purpose compound to drywall slightly beyond where the edge of the corner will be. Place

**NO-COAT**® corner on wall and press into position. Corner should be aligned tightly to the ceiling.

Embed trim by running knife over both sides of the corner with even pressure and squeeze out excess mud. Using the same knife, skim over the corner with the compound. Let dry.



Using a 6" – 8" finishing knife, skim over the corner once more. Let dry. Sand and paint.



Place **NO-COAT**® corner on wall and use roller to press into position. Corner should be aligned tightly to the ceiling.



**Box The Corner:** You can use your existing taping tools to finish your corners.



Corners will open and adjust to a 135° corner or any outside off-angle.

Manufacturer recommends installation with All-Purpose Joint Compound.

ULTRATRIM™

### BULLNOSE

Available in 3/8" or 3/4"

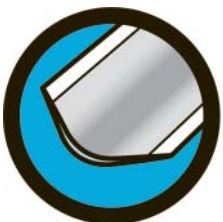

**BULLNOSE** offers perfect rounded corners everytime.



ULTRATRIM™

### L TRIM

Available in 1/2" or 5/8"



**L TRIM** is the ideal solution for suspended ceilings & window returns.

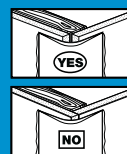

Using a 4" - 6" tapping knife, apply All Purpose compound to drywall slightly beyond where the edge of the corner will be. Place **NO-COAT**® corner on wall and press into position. Corner should be aligned tightly to the ceiling. Embed trim by running the knife over both sides

with even pressure and squeeze out excess mud. Using the same knife, skim over the corner with the compound, let dry.



Using a 6" – 8" finishing knife, skim over the corner.



Using a 4" - 6" tapping knife, apply All Purpose compound to drywall slightly beyond where the edge of the L-Trim will be. Place **NO-COAT**® L Trim on wall and press into position. Embed trim by running the knife over it with even pressure and squeeze out excess mud. Using the same knife, skim over the L Trim with the compound, let dry.

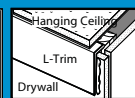

Using a 6" – 8" finishing knife, skim over the L Trim once more. Let dry. Sand and paint.



# Structural Laminate Drywall Corner System

## ULTRA ARCH™ OUTSIDE 90°



**OUTSIDE 90°** also opens to a 135° corner or adjusts to any outside angle and conforms to any drywall archway.

## ULTRA ARCH™ BULLNOSE

Available in 3/8" or 3/4"



**BULLNOSE** offers perfect rounded corners everytime and conforms to any drywall archway.

## ULTRATOOLS™

### ULTRATOOLS™

- WIDE OUTSIDE 90 & BULLNOSE ROLLER
- OUTSIDE 90 ROLLER
- INSIDE 90 ROLLER
- ONE-SIDED ROLLER
- NO-COAT DOUBLE BARREL HOPPER
- FLEX BRACKET FOR HOPPER (optional)



**NO-COAT's Structural Laminate (SLAM™) Corner System** actually becomes part of the structure. **SLAM™ Technology** integrates three key components that deliver superior strength and durability, flexibility, faster installation and dramatic bottom line savings.



Made With **SLAM™** TECHNOLOGY  
www.no-coat.com

**SLAM™ Technology** integrates **THREE KEY COMPONENTS** providing the durability, flexibility, and strength that won't crack under pressure.

**1. TAPERED HIGH STRENGTH CO-POLYMER CORE** withstands severe impacts. Won't rust. Requires less mud.

**3. FORMULATED SURFACE PAPER** eliminates cracks, chips and peels, resists abrasion, and accepts any finish.

**2. JOINT TAPE** permanently bonds corner to drywall with All Purpose mud.

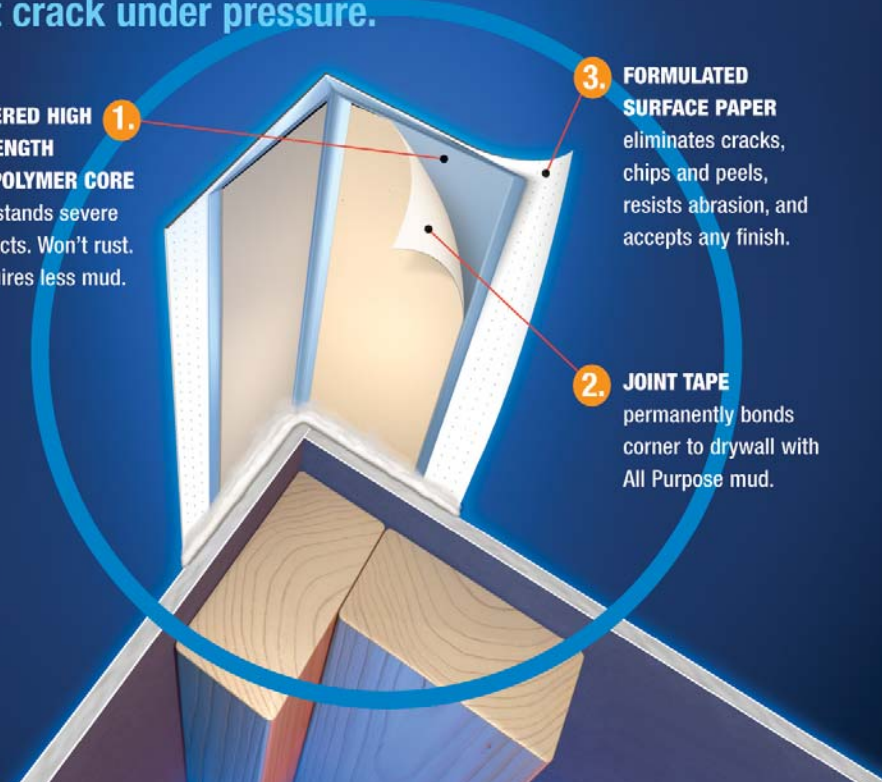



# Structural Laminate Drywall Corner System

## NO-COAT®

### ULTRAFLEX™

PRODUCT	DESCRIPTION	ITEM NUMBER	PACKAGING PER CARTON	PACKAGING PER PALLET
ULTRAFLEX 325	3.25" wide x 100' roll	ULT325	00.000	00.00
ULTRAFLEX 450	4.5" wide x 100' roll	ULTFLEX	00.000	00.00
ZOOMA-FLEX	2.125" wide x 100' roll	ZOOMA100	00.000	00.00
ZOOMA-FLEX	2.125" wide x 200' roll	ZOOMA200	00.000	00.00

### ULTRATRIM™

PRODUCT	DESCRIPTION	ITEM NUMBER	PACKAGING PER CARTON	PACKAGING PER PALLET
INSIDE 90	8'	SIC8	00.000	00.000
	9'	SIC9	00.000	00.000
	10'	SIC10	00.000	00.000
	12'	SIC12	00.000	00.000
OUTSIDE 90	8'	SOC8	00.000	00.000
	9'	SOC9	00.000	00.000
	10'	SOC10	00.000	00.000
BULLNOSE 3/8"	8'	SSB03808	00.000	00.000
	9'	SSB03809	00.000	00.000
	10'	SSB038010	00.000	00.000
	12'	SSB038012	00.000	00.000
BULLNOSE 3/4"	8'	SBO1358	00.000	00.000
	9'	SBO1359	00.000	00.000
	10'	SBO13510	00.000	00.000
	12'	SBO13512	00.000	00.000
BULLNOSE 135°	8'	SBO1358	00.000	00.000
	9'	SBO1359	00.000	00.000
	10'	SBO13510	00.000	00.000
	12'	SBO13512	00.000	00.000
WIDE OUTSIDE 90	8'	UTC8	00.000	00.000
	9'	UTC9	00.000	00.000
	10'	UTC10	00.000	00.000
	12'	UTC12	00.000	00.000
L TRIM 1/2"	10'	SL1210	00.000	00.000
L TRIM 5/8"	10'	SL5810	00.000	00.000

### ULTRA ARCH™

PRODUCT	DESCRIPTION	ITEM NUMBER	PACKAGING PER CARTON	PACKAGING PER PALLET
OUTSIDE 90	10'	A9010	00.000	00.000
BULLNOSE 3/8"	10'	AB3810	00.000	00.000
BULLNOSE 3/4"	10'	PUCRIL	00.000	00.000

### ULTRATOOLS™

PRODUCT	DESCRIPTION	ITEM NUMBER	PACKAGING PER CARTON	PACKAGING PER PALLET
WIDE OUTSIDE 90 & BULLNOSE ROLLER		PUCR	00.000	00.000
OUTSIDE 90 ROLLER		PSUCR	00.000	00.000
INSIDE 90 ROLLER		PUCRIL	00.000	00.000
ONE-SIDED ROLLER		000000000000	00.000	00.000
NO-COAT DOUBLE BARREL HOPPER		NCH1	00.000	00.000
FLEX BRACKET FOR HOPPER (optional)		000000000000	00.000	00.000

### TOTAL

Deliver to: \_\_\_\_\_

Street address: \_\_\_\_\_

City \_\_\_\_\_ State \_\_\_\_\_ Zip \_\_\_\_\_

Phone: \_\_\_\_\_ Fax: \_\_\_\_\_



Distributed in Canada by

